

ECLIPSE MAXI COLOUR SHIFTING DOWNLIGHT

SKU# 6232, 6387

Rated Voltage 220-240V~ 50Hz

To ensure correct function and safety, please read and follow all instructions carefully before assembly, installation and use of this luminaire. Please keep instructions for future reference.

Warranty

- This recessed luminaire is covered by a 2-year warranty valid for in-store replacement or refund only.
- The warranty period starts from the date of purchase, not the date of installation. Please retain the proof of purchase.
- The use of non-compatible dimmers may damage your recessed luminaire and will void your warranty.
- Warranty will be void if there is any damage due to improper usage or modification to the recessed luminaire.
- Failure to comply with the instructions in this manual may increase the risk of damage or injury and will void the warranty.

Installation Requirements

- Before the installation, check the installation location in the ceiling has access to a socket outlet which is connected to a wall light switch and dimmer. If it does not, please contact a licensed electrician to arrange installation of the socket outlet, wall light switch and dimmer before continuing.
- All wiring and installation of the recessed luminaire must adhere to latest local and national wiring rules. If unsure, please contact a licensed electrician.
- The front cover of the recessed downlight is rated IP44 only after it is fully installed. This must be maintained during installation. **NOTE: The recessed parts of the recessed downlight is rated IP40.**
- Select a suitable location for installation;
 - The mounting point must support 2 times the weight of the recessed luminaire.
 - This recessed luminaire is suitable for indoor or outdoor use, provided that it is installed under cover or under eaves.
- This luminaire is dimmable and was tested with the dimmers listed in the specification table at the date of publication. **NOTE:** Dimming may cause buzzing sounds or a slight flicker. There may be slight delays with the LED light start up or slight uneven light performance when more than one LED light fitting is linked together, switched ON or dimmed. This is not a product fault and as such is not covered under warranty.
NOTE: Some dimmers have a minimum load of 20W. Ensure the dimmer position is on the maximum setting before turning on the LED light and adjust the dimmer down to your desired light level.
NOTE: Testing cannot account for installation variables such as variation in mains supply voltage, cable capacitance, electrical noise, transients, surges and ripple control signals.
NOTE: The information provided is correct to the best of Zebbies Lighting's knowledge at the date of publication.
- If loose fill insulation or thermal insulation is not fixed into position or if there are loose combustible materials (e.g. leaves or combustible materials stored in the roof space), a barrier or guard is required as per the Clearance Information section in this instruction manual.
- The recessed luminaire must not be used if the diffuser has been cracked or damaged.
- Take care not to pull any electrical wires during unpacking as this may damage the connection.
- Lay out all the components on a smooth surface and make sure no components are missing before assembling. If parts are missing, return the complete product to the place of purchase for inspection or replacement.
- Check whether the luminaire has been damaged during transport. Do not operate/install any product which appears damaged in any way. Return the complete product to the place of purchase for inspection, repair or replacement.
- Ensure power to the circuit you are working on has been switched OFF before commencing any electrical work.

Installation Instructions

Installation Directions

1. Remove all packaging material from the product and be careful not to throw away accessories that may be hidden within the packaging material.
2. Select your preferred colour temperature (3000K-4000K-6500K) via the switch on the back of the recessed luminaire. (Fig. 2)

NOTE: The recessed luminaire must be turned off before using the switch to change the colour temperature.

3. Cut an installation hole of Ø90mm into the ceiling. (Fig. 1).
4. Connect the mains supply wire to the light fitting by using the terminal block provided. (Fig 2). Ensure that the wires are secure and no bare wires are exposed.

Mains Supply Wire

Neutral – Blue or Black
Live – Brown or Red

Fitting Wire

Blue or N
Brown or L

5. Push the springs up and put the recessed luminaire up through the cut-out hole and into the ceiling. (Fig. 3)
6. Ensure all the clearance values are maintained during and after installation of the recessed luminaire, thermal insulation, loose fill insulation, loose combustible materials and any structural members. (Fig. 4)
7. After the installation, switch on the luminaire on to test all the lighting functions and enjoy your new luminaire.

Specifications		
SKU #	6232	6387
Colour	White	Black
Rated Voltage	220-240V~ 50Hz	
Rated Wattage	8W	
LED Specs	Shineon LEDs, Dimmable, Colour Switching, CRI ≥ 80	
Rated Lumens	3000K - 750 lumens 4000K - 850 lumens 6500K - 800 lumens	
Compatible Dimmers	Clipsal: 31E2PUDM, 31E2RUDM, 32E450UDM. DIGINET: LED Smart MEDM. HPM: Cat. 400T SDIM-T-LED-500W	
Weight	0.2kg	
Cut-out Size	Ø 90mm	
IP Rating	IP44 for the front cover of the LED downlight (after installation) IP40 for the back of the LED downlight (recessed parts)	
Dimensions	H:58mm Dia:115mm	

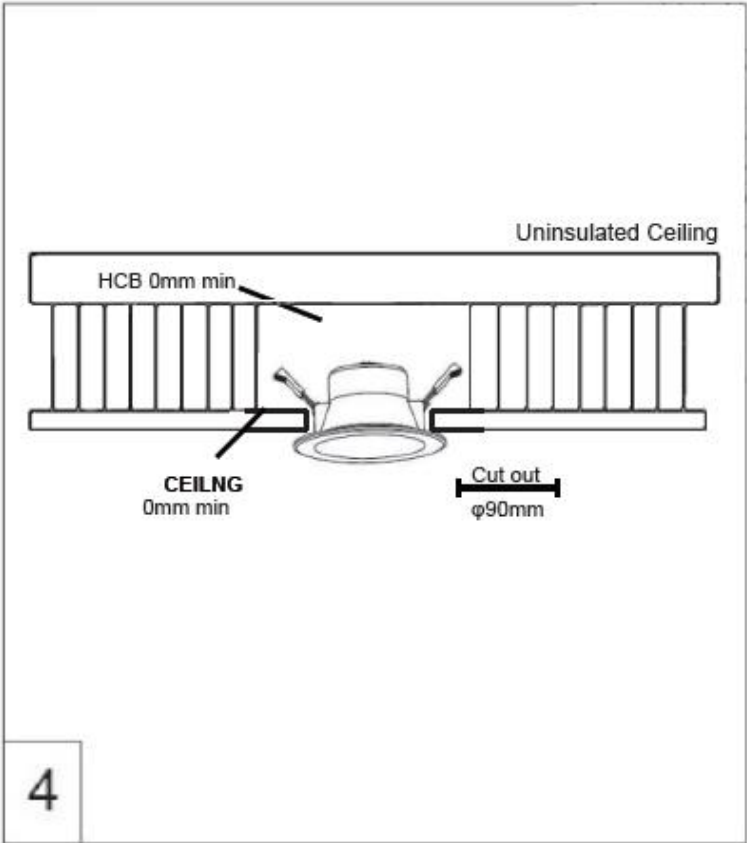
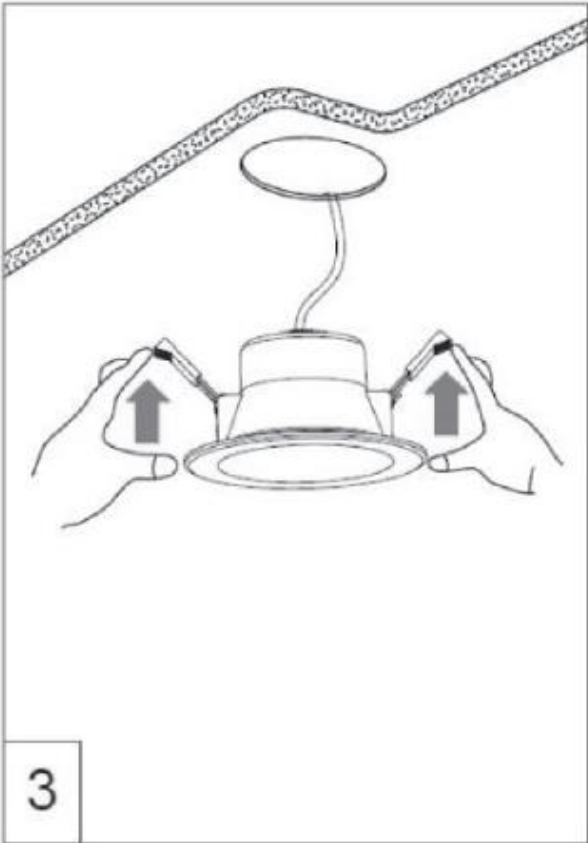
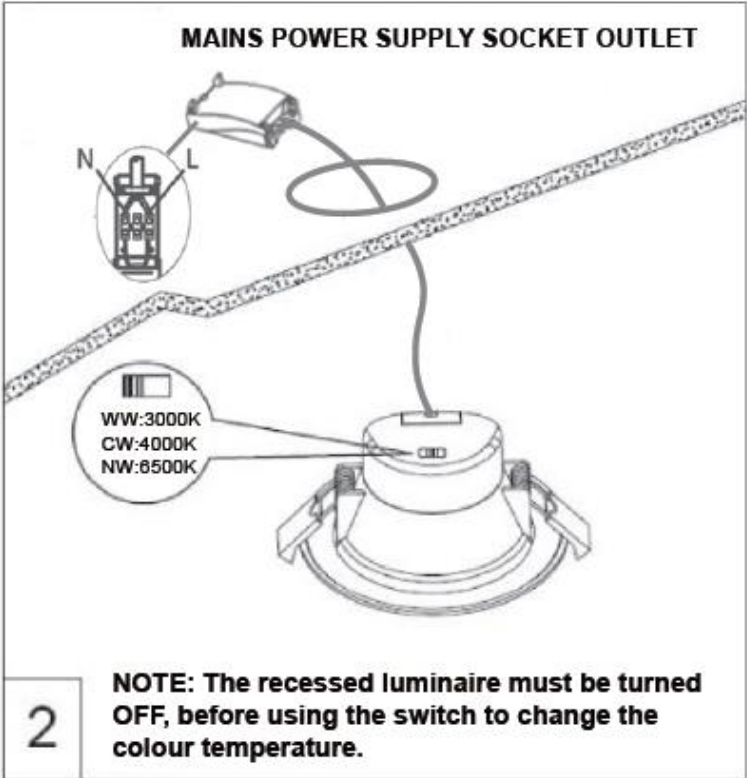

Troubleshooting		
PROBLEM	POSSIBLE CAUSE	SUGGESTED SOLUTION
Does not work. (New installation)	Wiring loose or no power to the downlight.	Check your circuit breaker/safety switch box and turn on power to your circuit.
		Unplug the downlight and test in a functional socket outlet with power. If the downlight does not switch on then contact your place of purchase. If the downlight is working, have your licensed electrician check the wiring or socket outlet to the downlight.
Does not work. (Existing installation)	No power to the downlight.	Check your circuit breaker/safety switch box and turn on power to your circuit.
		Contact your place of purchase.
Flickers when dimming. (New installation)	Non-compatible dimmer used.	Check the dimmer used. Ensure the dimmer used is on the list of compatible dimmers in this manual.
	Some dimmers have a variable loading adjustment function. This may not have been adjusted during the installation of the dimmer.	The variable resistor needs to be adjusted to suit the downlight load to reduce the flickering.
Flickers when dimming. (Existing installation)	Dimmer position on low.	Ensure the dimmer position is on the maximum setting before turning on the downlights and adjust the dimmer down to your desired light level.
Buzzing sound.	Non-compatible dimmer used.	Check the dimmer used. Ensure the dimmer used is on the list of compatible dimmers in this manual.
Uneven light start up.	Dimmer position on low when switched on.	Ensure the dimmer position is on the maximum setting before turning on the downlights and adjust the dimmer down to your desired light level.

Safety Tips

- Always ensure the power is OFF and the recessed luminaire has cooled down before performing any maintenance, cleaning or making any adjustment to the recessed luminaire.
- The external flexible cable or cord of this luminaire cannot be replaced; if the cable or cord is damaged, the luminaire shall be destroyed.
- The recessed luminaire must not be used if the diffuser/protective shield has been cracked or damaged.
- The light source of this luminaire is not replaceable; when the light source reaches its end of life the whole luminaire shall be replaced. There are no serviceable parts, do not attempt to dismantle or open the product.
- To avoid injury or damage to the luminaire, ensure that power leads and screws are secure before connecting the power.
- Ensure the recessed luminaire does not come in contact with corrosive chemicals/solvents or abrasive cleaners etc.
- To clean, wipe with a soft damp clean cloth. Do NOT soak or immerse the product in water or other liquids.