

# Installation Instructions

## WARNINGS AND CAUTIONS

IMPORTANT:

TO BE INSTALLED BY QUALIFIED ELECTRICIAN CAUTION

Before starting the installation, disconnect the power by turning off the circuit breaker

Or by removing the fuse at the fuse box.

Turning the power off using the light switch is not sufficient to prevent electrical shock

## ASSEMBLY AND INSTALLATION

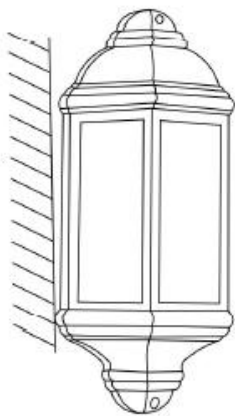

1. Put the wire [A] (outside power) with lighting wire [B] together by wire box [C]

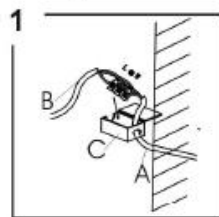

2. Put the mounting [F] on the wall by M5-screw [E] and pipe [J]

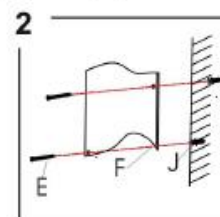

3. Install light bulb [K] use only watt or less as the watt label list

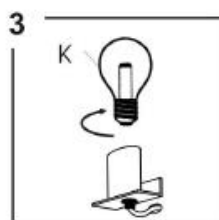

4. Put the body [H] on the mounting [F] by screw [L]

