

# CEILING FAN MANUAL

- INSTALLATION
- OPERATION
- MAINTENANCE
- WARRANTY INFORMATION

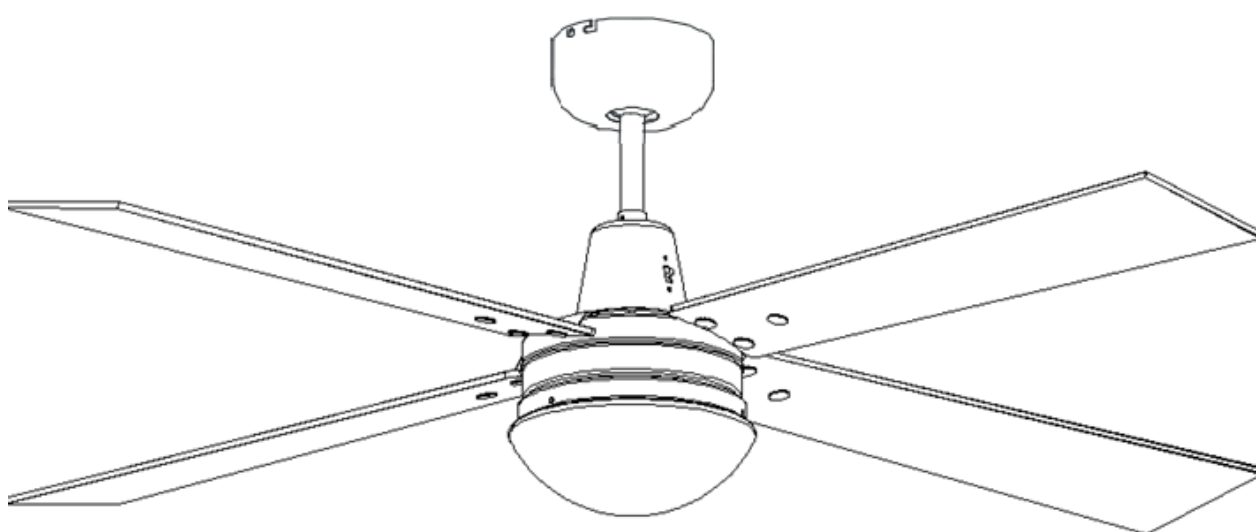

**CEILING FAN# 2566**

## **CAUTION**

**READ INSTRUCTIONS CAREFULLY FOR SAFE  
INSTALLATION AND FAN OPERATION.**

## **SAFETY PRECAUTIONS**

The information contained in the following pages has been prepared to ensure trouble-free operation of your Ceiling Fan .

1. To ensure the success of the installation be sure to read the instructions and study the diagrams thoroughly.
2. For your safety, all electrical connection and disconnection must be performed by a Licensed Electrician.
3. All electrical work should only be undertaken after disconnection of the power by removing fuses or turning off the circuit breaker to ensure all pole isolation of the electrical supply. If you are in any doubt the services of a qualified electrician should be sought to ensure that all work is carried out in accordance with the local regulations, current good practice and other national and local electrical codes.
4. Make sure that your installation location will not allow the rotating fan blades to come into contact with any object and that there is a minimum clearance of 30cm from the blade tip to the wall or nearest object. Please note that the bigger this clearance is the better the airflow from your fan will be. Ensure the blades are mounted at a minimum height of 2.3 meters from the floor when the fan is installed.
5. The fixing point for the fan must be able to support a weight of at least 30kg. If you are mounting the fan to a ceiling junction box, the box and it's fixing must be able to support the moving weight of the fan and must not twist or work loose.
6. The fan must be earthed.
7. Do not connect the fan motor to a dimmer switch. This may give an unsatisfactory performance (motor hum) and cause damage to the motor. Only use the supplied remote control.
8. It is not recommended that ceiling fans and gas appliances be operated in the same room at the same time.
9. The fan must be turned off and stopped completely before reversing the fan direction. This will prevent any damage to the motor of the unit or controller (if installed).
10. Do not insert anything into the fan blades while the fan is operating, as this may cause personal injury, damage the blades, and upset the balance of the unit causing the unit to wobble.
11. After the fan is completely installed make sure that all connections are secured and tightened to prevent any problems.
12. Because of the fan's natural movement, some connections may loosen. Check the support connections, brackets and blade attachments twice a year to make sure they are all secured. If they are loose, tighten with a screwdriver.

**Note:** The important safeguards and instructions given in this manual are not meant to cover all possible conditions and situations that may occur. It must be understood that common sense, caution and care are factors, which cannot be built into any product. The persons caring for and using the unit must supply these factors.

For installation advice, or in the unlikely event of damaged or missing parts please consult a licensed electrician.

## IMPORTANT NOTES

### FAN CONTROL

**ONLY** use the remote control supplied.

Without this remote control there is a strong possibility that the ceiling fan motor will produce an unpleasant loud humming noise.

### FAN INSTALLATION

Under our warranty terms, this ceiling fan must be installed by a licensed electrician. Improperly installed ceiling fans can be dangerous and expensive to repair. This voids the warranty too. This fan is designed for indoor use only, mounting where the fan is subject to water or moisture can be dangerous and also void the warranty.

### FAULT FINDER

Always check the “Trouble Shooting Checklist” included in this booklet before calling for service. Unnecessary calls are inconvenient for all and can attract a service charge.

**MECHANICAL NOISE MAY BE NOTICED ON INSTALLATION-ALLOW AT LEAST 8 HOURS SETTLING-IN PERIOD. SOME FANS WOBBLE MORE THAN OTHERS—EVEN IN THE SAME MODEL; IT DOES NOT MEAN THE FAN IS FAULTY.**

### WARNING

This appliance is not intended for use by persons (including children) with reduced physical, sensory or mental capabilities, or lack of experience and knowledge, unless they have been given supervision or instruction concerning use of the appliance by a person responsible for their safety.

Children should be supervised to ensure that they do not play with the appliance.

The fan must be installed so that the blades are at least 2.3 meters above the floor.

The important safeguards and instructions appearing in this manual are not meant to cover all possible conditions and situation that may occur. It must be understood that common sense, caution and care are factors, which cannot be built into any product. These factors must be supplied by the person(s) caring for and operating the unit.

## BEFORE INSTALLATION

Unpack your ceiling fan carefully. Remove all parts and hardware. Place fan motor on a cloth or soft surface to avoid damaging the finish.

Verify that all parts are present before starting assembly. And check the packaging carefully for missing parts.

Examine all parts. You should have the following:

- Wall plugs (1) for Screw (6) x 2
- Canopy screw (2) x 4
- Hanger Bracket (3) x 1
- Screw (6) for Hanger bracket x 2
- Bladed screws (7) x 9
- Blade holder screw set (8,11) x 13
- Blade holder (9) x 4
- Blade (10) x 4
- Pre-assembled Fan Motor, down rod and canopy x 1
- Decorative Cover (13) x 1
- Light connector (14) x 1
- Light base (15) x 1 (For models with light function only)
- Screw nut (16) x 1 (For models with light function only)
- Glass shade (17) x 1 (For models with light function only)
- Remote control (18) x 1

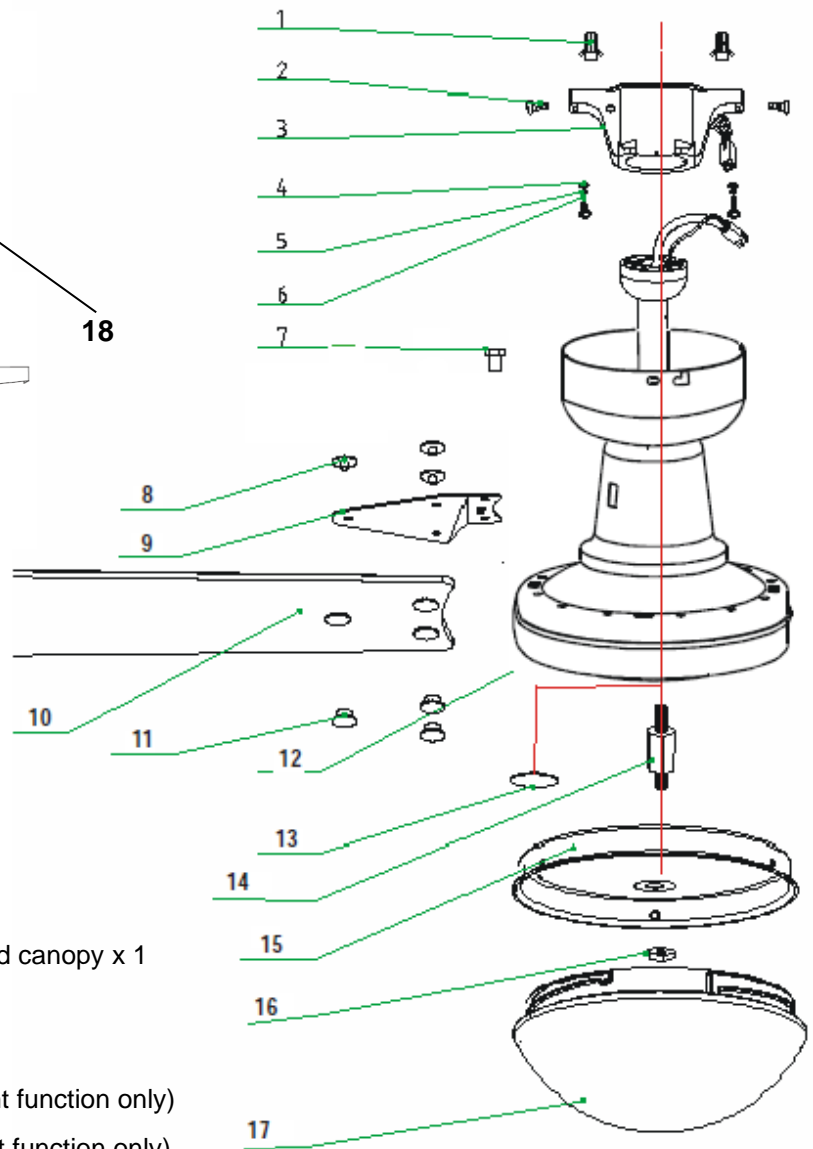

**NOTE:** Some models do not include the light kit, please refer to product specification.

# FAN ASSEMBLY

## TOOLS REQUIRED

- Phillips / Flat head screw driver
- Pair of pliers
- Adjustable Spanner
- Step ladder
- Wire cutter

**NOTE: MECHANICAL NOISE MAY BE NOTICED ON INSTALLATION-ALLOW AT LEAST 8 HOURS SETTLING-IN PERIOD. SOME FAN WOBBLES MORE THAN OTHER—EVEN IN THE SAME MODEL.**

**NOTE: Unlike most ceiling fans, you must attach the blades to the motor housing BEFORE mounting the motor to the ceiling. When installing more than one fan, ensure that the blades sets are not mixed up as each set is dynamically balanced.**

The AIRFUSION series ceiling fans are now packaged with the motor, down rod and canopy pre-assembled. Before installation, please check to ensure all screws and nuts are re-tightened as they may become loose during transportation.

## BLADE ATTACHMENT:

1. Assemble the blade and blade holder together with screw set.
2. Before installing the blades, remove the motor screws that was locked into the motor in advance
3. Align and insert the hook of blade holder into the square hole of motor.
4. The motor holds the blade via the hook, and then secure the blade on the motor via tightening 2 motor screws with washers.
5. Ensure that the 2 motor screws are tightened at the same time. Do not tighten one screw first, and do not over tighten the screws as this can damage the blades. Repeat this process for all blades.

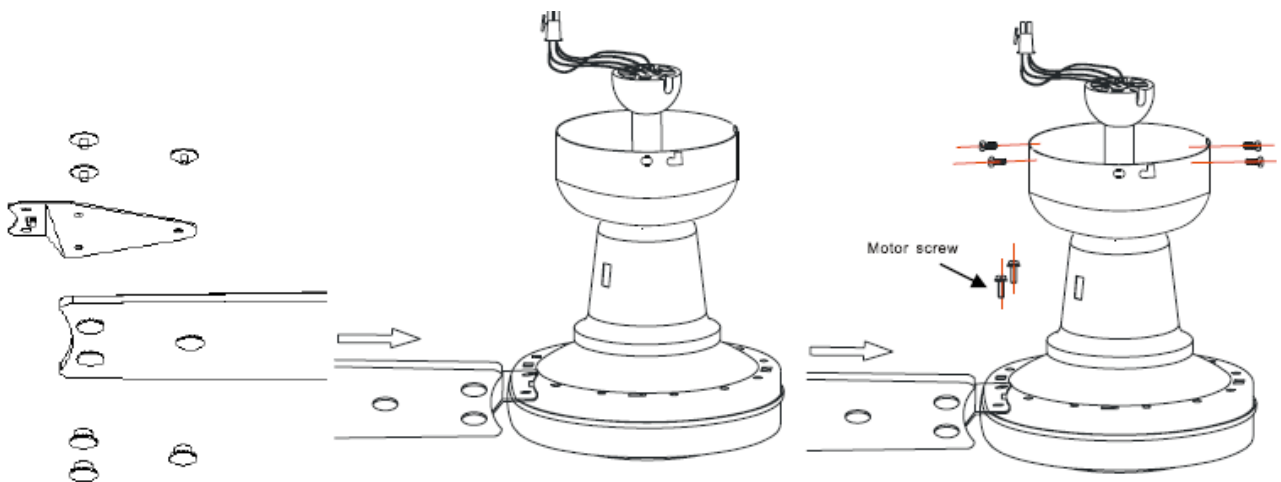

## INSTALLING THE FAN

1. The ceiling fan must be installed in a location so that the blades are at least 2.3 meters above the floor, and 300mm spacing from the tip of the blade to the nearest objects or walls.
2. Secure the hanging bracket to the ceiling joist or structure that is capable of carrying a load of at least 30KG, with two long screws provided. Ensure at least 30mm of the screw is threaded into the support.

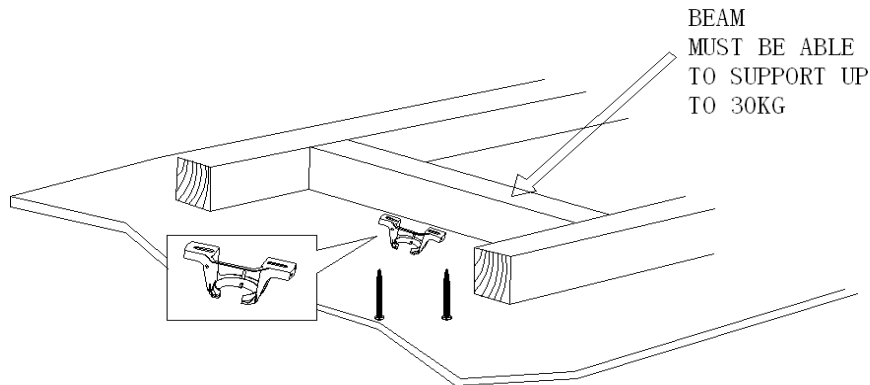

**FIG. 3 NOTE: Picture is for representation only and may not represent the actual bracket.**

3. Carefully lift the fan and seat the down rod ball assembly into the spacing allocated in the mounting bracket and lock the ball into place.
4. Refer to the wiring diagram provided for Electrical Connection/installation.(NEXT PAGE)

**WARNING:** To prevent electrical shock or risk of fire, do not attempt to perform the electrical connection wiring yourself. All Electrical connections must be carried out by a qualified Licensed Electrician.

**NOTE:** An additional all pole disconnection switch **MUST** be included in the fixed wiring.

5. After completing the electrical wiring at the mounting bracket terminal and connecting the ceiling and fixed wiring via the quick connector, cover the mounting bracket with the canopy cover. Ensure all electrical wirings are tucked inside the canopy cover and that they are not damaged during this step, and secure with screws.

**NOTE:** The bracket screw provided is for use with wooden structure only. For structures other than wood, the appropriate screw type **MUST** be used.

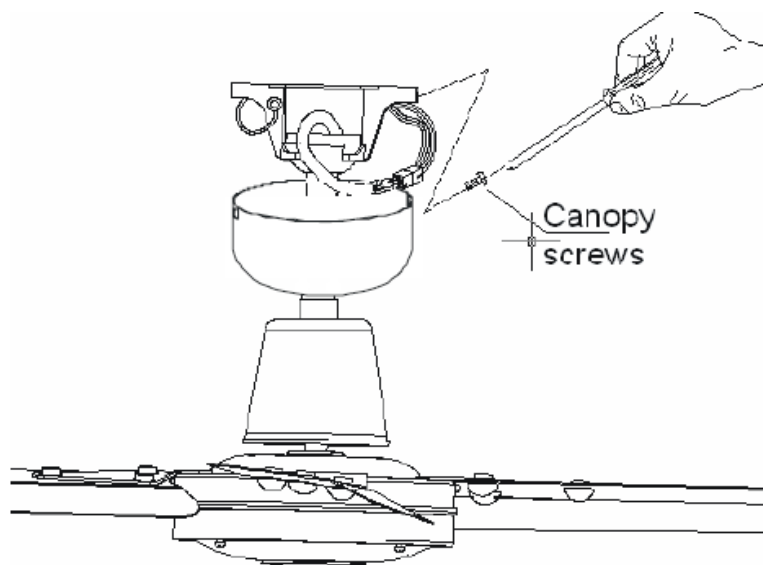

# ELECTRICAL WIRING DIAGRAM

## WIRING

The wiring can now be installed ready for connection to the Receiver.

Wiring requirement when connecting to remote receiver:

- Connect main supply Live wire to “L” (BROWN WIRE)
- Connect main supply Neutral wire to “N” (BLUE WIRE)
- Connect Earth wire to “E” (GREEN-YELLOW WIRE).

**NOTE:** AN ISOLATION SWITCH SHOULD BE INSTALLED SOMEWHERE IN THE FIXED WIRING OF A REMOTE FAN IN CASE REMOTE IS LOST, OR FOR SERVICING OF THE FAN.

**NOTE:** REMOTE FANS **CANNOT** BE CONTROLLED BY A SPEED WALLSWITCH OR LIGHT WALL SWITCH.

### ELECTRICAL WIRING DIAGRAM :

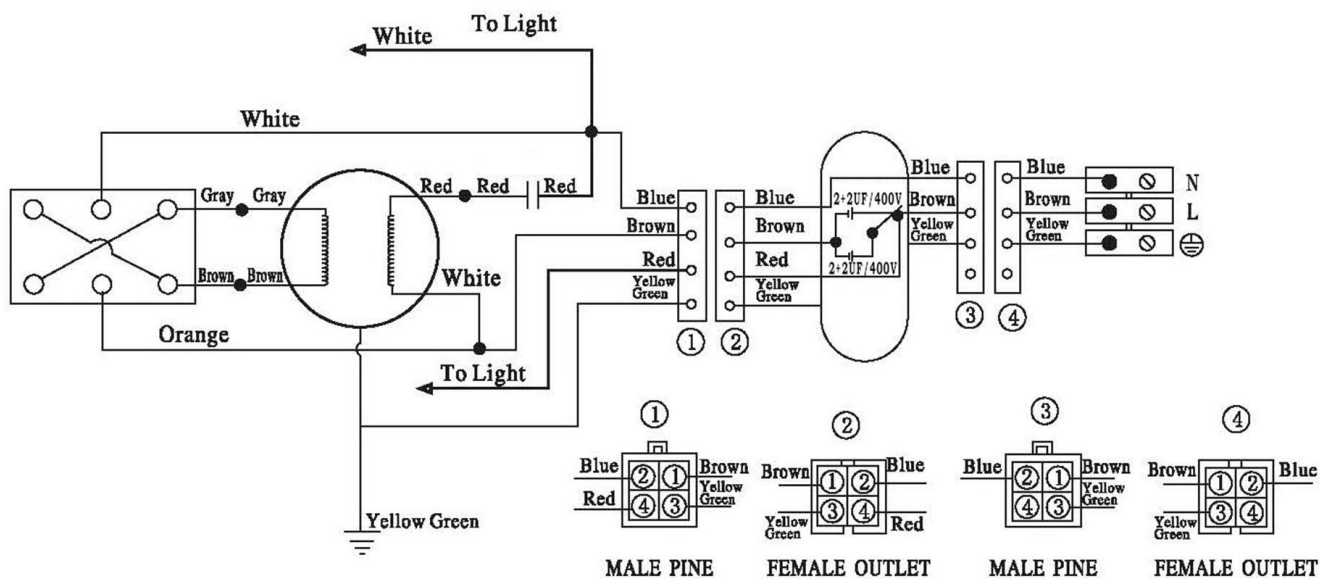

**NOTE:** The light switch wiring diagram is omitted for models that do not have the light feature

# REMOTE CONTROL OPERATING INSTRUCTION

## HOW TO USE THE FAN/LIGHT WITH REMOTE CONTORL

This ceiling fan remote control is only suitable for controlling the fan motor and the light kit associated with the ceiling fan. Any other use would be considered as misuse and warranty would be void. · Do not use a solid state dimmer with this ceiling fan remote controller



Receiver (controller)



Transmitter (remote)

This remote control is designed to control your ceiling fan speed and light.

## Installation preparation

**Before carrying out the installation, the following must be considered.**

- 2 x AAA 1.5V (size) batteries are required to operate the remote control. Remove the battery cover from the back of the remote and insert 2 x AAA batteries. Ensure the polarities are correct as shown in the battery compartment. And that the batteries are all fresh batteries (batteries are not included).
- The transmitter and receiver must be configured so that communication between each other is paired up. This is achieved by setting the DIP switch on the receiver and transmitter on the same setting.

Note: The DIP switch assembly has 4 switches which can be setup to 16 different transmitting code combinations. This is practical when there is more than 1 remote/receiver pair operating locally or in the same room.

**Note: To access the receiver DIP switches, remove the DIP switch cover.**

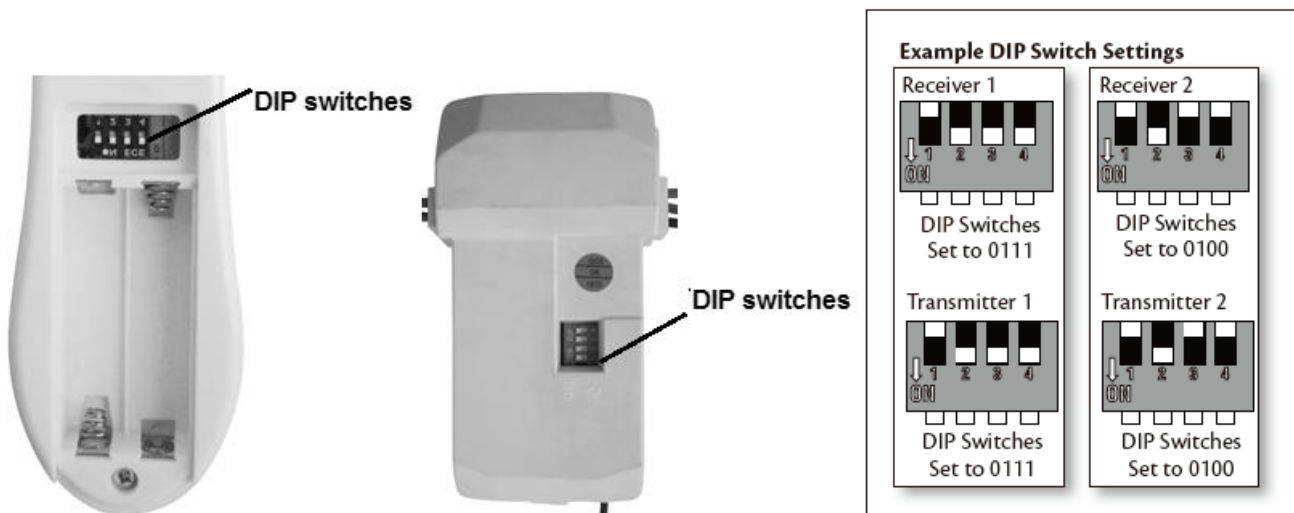



## Installation directions

### WARNING – HIGH VOLTAGE

BEFORE CONNECTING THE RECEIVER & CHANGE CODES

- **For your safety: Power to the circuit must be disconnected or switched off.**
- **Household power can cause SERIOUS INJURY or DEATH.**
- **Wiring must meet all local and national electrical wiring codes.**

### MAKING THE ELECTRICAL CONNECTIONS

Use the wire nut terminal block provided for making connections.

1. Disconnect electrical power from the working circuit.
2. Remove the ceiling fan CANOPY cover from the mounting bracket.
3. Disconnect existing wiring from the supply at ceiling.
4. Connect the earth (GREEN/YELLOW) wire to the supply EARTH wire, and ensure continuity for the whole electrical earth wiring.
5. Connect **AC IN L** of control unit to **AC L** supply wire.
6. Connect **AC IN N** of control unit to **AC N** supply wire.
7. Connect **TO MOTOR N** of control unit wire to the **MOTOR (N)** fan wire.
8. Connect **TO MOTOR L** of control unit wire to the **MOTOR (L)** fan wire.
9. Connect **FOR LIGHT** of control unit wire to the **LIGHT (L1)** fan wire.
10. Push the connected wires up into the junction box.
11. Lay the control unit wire on top of the control unit.
12. Lay the control unit in the CANOPY.
13. Reinstall the canopy on the mounting bracket.
14. Restore electrical power to the circuit.

### Operating the remote

Before you start using the remote, take the time to read through this section and get familiar with the function of each button.



**LED Indicator:** The red LED indicator on the top of transmitter will flash when the buttons are active.

**HI:** Press the button to set fan running speed to high.

**MED:** Press the button to set fan running speed to medium.

**LOW:** Press the button to set fan running speed to low.

**OFF:** Press the button to turn OFF the fan.



: Press the button to turn ON/ OFF the light.

The remote has memory function. If the fan or light is turned off by the wall switch, it will memories and recover the last status when turned on next.

**NOTE: MECHANICAL NOISE MAY BE NOTICED ON INSTALLATION-ALLOW AT LEAST 8 HOURS SETTLING-IN PERIOD. SOME FAN WOBBLES MORE THAN OTHER—EVEN IN THE SAME MODEL.**

### **REVERSING SWITCH**

Your ceiling can operate either in fan mode or reverse fan mode.

**SUMMER Mode:** The reverse switch shall be in the “down” (SUMMER) position to make the fan rotate in an anticlockwise direction. The airflow will be directed downwards, for cooling in summer.

**WINTER Mode:** The reverse switch shall be in the “up” (WINTER) position to make the fan rotate in clockwise direction. The airflow will be directed upwards, for energy conservation in winter.

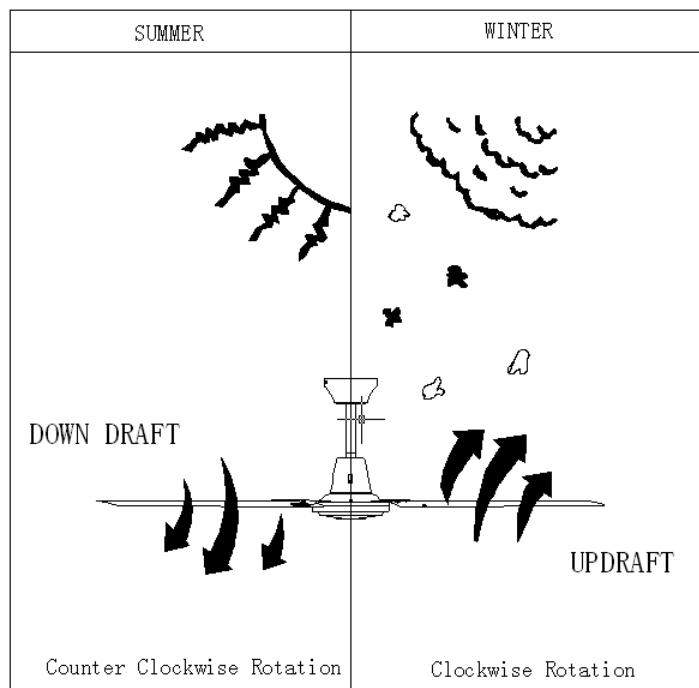
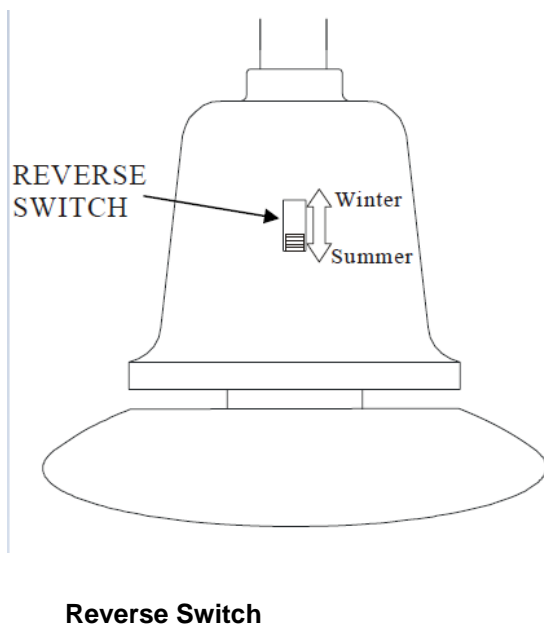

**NOTE: MECHANICAL NOISE MAY BE NOTICED ON INSTALLATION-ALLOW AT LEAST 8 HOURS SETTLING-IN PERIOD. SOME FAN WOBBLES MORE THAN OTHER—EVEN IN THE SAME MODEL.**

### **LIGHT KIT Installation (Light kit - optional)**

**Note:** Light kit must be installed by a Licensed Electrician.

**NOTE:** The light kit is available for selected ceiling fan models and as an optional light kit.

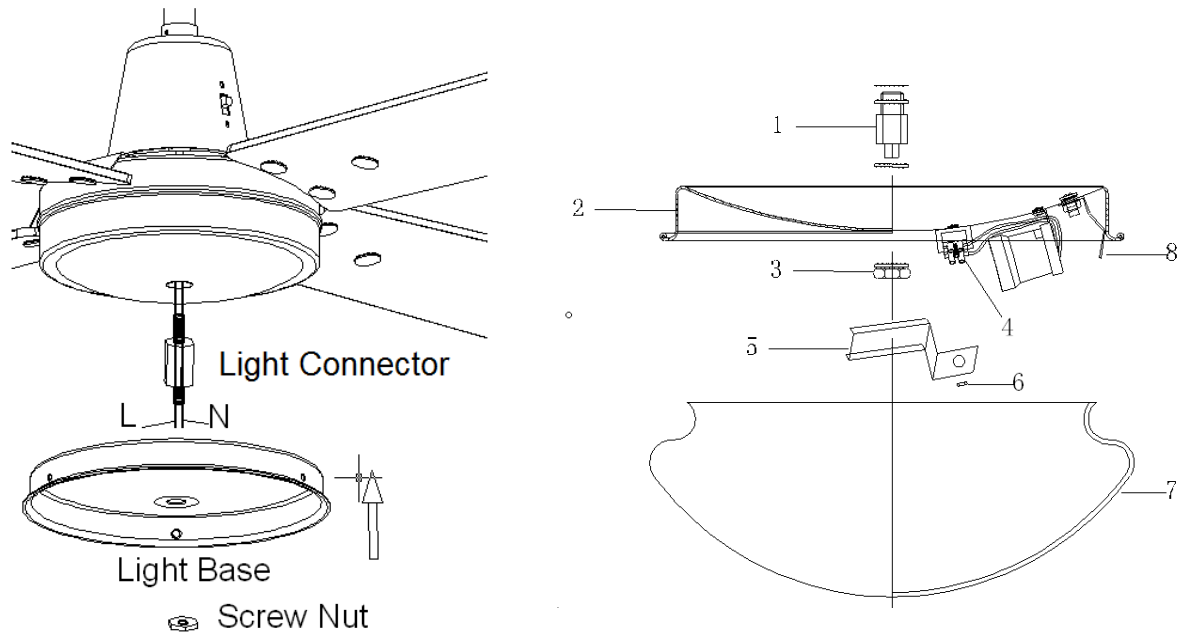

1. Loosen the decorative cover from the shaft.
2. Pull the L wire and N wire for light out from the shaft.
3. Insert wires through the light connector (1). Long and round end of threaded tube is connected to shaft.
4. Tighten the light connector firmly into the shaft with a spanner.
5. Secure the light base (2) to copper connector (1) via tightening the screw nut (3).
6. Take off the wire protective cover (5) from terminal block (4) via loosening the screw nut (6).
7. Connect the L wire and N wire from fan to the terminal block (4) on the light base according to the label.
8. Re-install the wire protective cover.
9. Install the bulbs (not included). The bulb must not exceed the specified wattage on the label.
10. Lift and attach the glass (7) to the lamp base and secure it via using three spring clips (8).

### **BALANCING KIT**

**Balancing Kit** is provided to balance the ceiling fan on initial installation. Please refer to the instruction on how to use the Balancing Kit.

The balancing kit can be used to assist re-balancing should the ceiling fan becomes un-balanced again, so store your balancing kit away after first use.

## BALANCING / WOBBLYING TROUBLE SHOOTING

Please note that all ceiling fans are not the same, even in the same model—some may move more or less than others. Movement of a couple of centimetres is quite acceptable and does not suggest the fan will fall down or any fault.

Even though all blades are weighted and grouped by weight, it is impossible to eliminate wobble altogether and should not be considered a problem. Ceiling fan tend to move during operation due to the fact that they are not generally rigidly mounted

You may do the following action to reduce the wobbling

- 1) Check all the blade mounting screws are tightened and secured.
- 2) Wobbling problems may result from inconsistent blade level. To check blade level, measure the distance from each blade tip to the ceiling.

Note: If measurements are inconsistent:

- check blade mount screws are not over tightened or loose which can cause the blade tip to be not all levelled; **FIG.10**
  - An out of shape blade can cause wobbling, check by removing the blade and lay in on a flat surface. A good flat blade will lay flat on the surface.
- 3) Blade tracking may be checked simply by use of a household yardstick as shown in Figure 10. Place the yardstick vertically against the ceiling and even with the outside leading edge of a blade. Note the distance of the edge of a blade is the same as others. Turn the blade slowly by hand to check the remaining blades are the same mark on the stick. If a blade is not in alignment, the blade is either out of shape / warp or the blade screws are not evenly tighten or either loose.

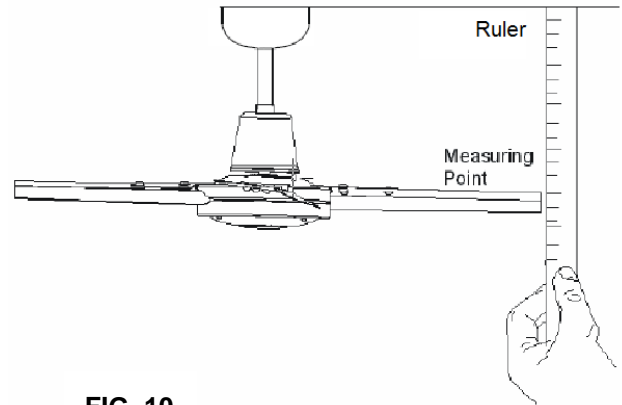

**FIG. 10**

## FAN CARE AND WARRANTY INFORMATION

### CARE & CLEANING

- Periodic cleaning of your ceiling fan is the only maintenance required. Use a soft brush or lint free cloth to avoid scratching the paint finish. Please turn off electricity power when you do so.
- Do not use water when cleaning your ceiling fan. It could damage the motor or the wooden blades and create the possibility of an electrical shock.
- Motor has permanently lubricated ball bearing. There is no need to oil.

## WARRANTY SERVICE

The manufacturer warranty covers actual faults that may develop, but **NOT** minor complaints, e.g. noise from motor run—**ALL ELECTRIC MOTORS ARE AUDIBLE TO SOME EXTENT.**

## WOBBLE

- Ceiling fan tend to move during operation due to the fact that they are not generally rigidly mounted—if they were, they could generate excessive ceiling vibration and stress on their mountings.
- Movement of a couple of centimetres is quite acceptable and does not suggest the fan will fall down or is faulty.
- Ceiling fans are mounted very securely on steel brackets with rubber cushioning or with ball-joints to allow free movement.
- Please note that all ceiling fans are not the same, even in the same model—some may move more or less

## NORMAL WEAR AND TEAR

Threaded components working loose or blade carriers slightly bent due to vigorous cleaning or bumping can cause extra wobble and noise. **THIS IS NOT COVERED UNDER WARRANTY-** a little care and maintenance can reduce or prevent this problem.

## NOISES-IN-THE NIGHT

This is the biggest cause for service calls, which are outside the manufacturer's warranty. If a fan has a fault, it will be noticeable at all times. Naturally, when everything is quiet at night, you will be more inclined to hear small noises, which may not be noticeable at other times. Even slight power fluctuations, and mains frequency signals superimposed in your electricity supply for off-peak hot water control may cause a change in fan motor noise. This is normal. (For additional information refer to ripple control – next page).

## FAN LIGHT

Except for actual fault in manufacture, which are extremely rare. **FAN LIGHTS AND BULBS ARE NOT COVERED UNDER YOUR FAN WARRANTY.** Noises and vibration etc. are often more accentuated when a fan light is fitted.

For instance a fan light glass that has not been tightened or worked loose can cause a rattle. Again, care and maintenance will reduce this.

Any damaged glass must be returned to the retailer within 14 days of purchase.

## WARNING

- The fan must be installed so that the blades are more than 2.3 meters above the floor.
- All electrical connections must be installed by licensed electrician. This ceiling fan is within this requirement
- According to our warranty terms, only faulty fans installed by licensed electrician will be covered by a warranty service.

## NOTES TO INSTALLERS

- All electric motors, including fans make some noise and may feel hot if touched—this is not a fault.
- Some fan wobble more than other—even in the same model.
- Fan lights can rattle, but are not covered under warranty
- These occurrences are not covered by the manufacturer's warranty.

## TROUBLE-SHOOTING CHECKLIST

TROUBLE	PROBABLE CAUSES	SUGGESTED REMEDY
<b>1. Fan will not start</b> <b>(Warning: THE ceiling must be switched OFF, and the assistance of a licensed electrician maybe required.)</b>	A. Fuse or circuit breaker blown.	Check main and branch circuit fuses or circuit breakers.
	B. Loose power line connections to the fan.	Check line wire connections to fan
	C. Speed controller not in correct position.	Check speed controller's position.
<b>2. Fan Wobbles</b> (Refer to Wobble section of the manual for further information.)	A. Fan blades are not horizontal to ceiling.	Refer to "BALANCING/WOBBLYING TROUBLE SHOOTING" section of manual. <ul style="list-style-type: none"> <li>- The blades may require adjustment at the blade mounting screws;</li> <li>- The blades are out of shape, thus causing wobbling. New set of blades will be required. Contact your local Zebbies Lighting shop.</li> </ul>
	B. Blade screws are loose.	Make sure all screws are securely fastened.
	C. Blade/s are out of shape	Remove blade and lay on a flat surface to check if blades are out-of-shape. Contact Zebbies Lighting for replacement blades, if blades are out of shape.
<b>3. Fan sound noisy</b>	A. Top canopy touching ceiling.	Lower Canopy from ceiling to ensure minimum 3 mm clearance.
	B. Loose fan blade screws.	Re-tighten all screws on fan blades but never over-tighten.
	C. Ceiling fan not secured against ceiling.	Re-tighten all screws in the hanging bracket or plate.
	D. Incorrect speed controller.	Change the controller to the one supplied.
	E. Audible buzzing noise. Cause by Ripple Control signals. Please refer to the Ripple Control section of this manual.	Install a Ripple Control filter. (Refer to the Ripple control information in this manual.)
<b>4. Mechanical Noise</b>	A. Allow at least for 8 hours settling-in period.	
<b>5. Light will not turn ON (Optional light kit ONLY)</b>	The bulb/lamp has failed.	Replace bulb/lamp

**WARNING: THE CEILING FAN MUST BE SWITCHED OFF, BEFORE ANY TROUBLESHOOTING IS PERFORMED.**

## TECHINCAL INFORMATION

Ceiling Fan model	Rated Voltage	Rated Power (motor)
#2566– 48' blade	220-240 VAC	65W

## **WARRANTY CONDITIONS**

This product is guaranteed against electrical defects in material or manufacturing workmanship for faults when under normal domestic/residential conditions for a certain period of time from the date of purchase. This warranty covers parts and labour costs for the motor subject to the following conditions:

1. Installation being performed by a qualified licensed Electrician.

This warranty will not apply if the ceiling fan is installed by anyone other than a licensed electrician. Problems arising from incorrect installation are not covered by warranty. The cost of repairs and/or service call where the defect is due to the installation and not due to faulty material or workmanship, in accordance with wholesaler and their authorized agent, will be payable at time of repair.

2. The correct controller being fitted to the fan.

Only use the controller supplied with the fan or a genuine replacement. Using solid-state dimmer type or non-genuine controllers will void the warranty. Use of non-genuine controllers may cause the fan to operate with a loud hum and at altered speeds. Where controllers are supplied complete with light switch – do not use this switch to operate the fan. Fans connected using this switch to turn the fan on/off, will not be covered by warranty.

3. Repair work being carried out by licensed electrician only after authorization by wholesaler or their authorized agent to complete the repair and is subject to the supply of dated proof of purchase and installing electricians details.
4. The exclusion from warranty of any changes to ceiling fan blade or motor, plated and/or painted finishes due to climatic conditions (moisture, salt air etc) or after 6 months from the date of purchase or other circumstances deemed to be beyond the control of wholesaler or their authorized agents.
5. The warranty service does not cover:

- a. Transportation and in-transit insurance costs, if the product or parts thereof have to be returned for repair or replacement to the retailer or their authorized agent.
- b. Repair of defects caused by accident, fire, misuse, alterations modification, negligence, incorrect or incomplete installation/operation, any unauthorized person attempting to repair the ceiling fan, or acts of God.
- c. Claims or damage to furniture, carpet, wall, ceiling foundations or any other consequential loss either direct or indirectly resulting from a faulty ceiling fan.

6. The warranty applies to actual faults which may develop. Minor running noises are not covered. All electrical motors have some audible noise. Allow at least eight hours of operation to allow the bearings to properly seat. The fan, especially when set on low, may feel warm to touch – this is not a fault. If excessive heat is generated a service call may be required. Fan noises can vary due to slight power fluctuations and mains frequency signals for off – peak-controlled appliances. These changes are most noticeable in the quiet of night, mains frequency signals which come across as an intermittent hum (mostly at night) are out of control of the manufacturer in these cases your electricity provider should be contacted, or an electrician to fit a suitable noise filter.

7. Threaded components such as blade nuts can work slightly loose during normal operation. These should be tightened regularly to ensure the fan doesn't develop operation noises. If noises do develop, check this aspect before requesting service. This is not covered by warranty.
8. Minor variation of speed may be evident between different fans, even in the same model and is not a product fault and not covered by warranty.
9. Blades are not covered by warranty against defect in material. The replacement of the blades is not covered by the in home warranty service call, notification within 48 hours of installation is required where blades have found to be broken on unpacking, contact the retailer who will send you a new set of blades. Each blade set is balanced so it is important to replace all blades. Blades affected by climatic conditions and by maintenance are not covered by this warranty.

For under warranty service, contact the hotline number in this booklet and advise: the model number and style, the nature of the fault, date and place of purchase. Service cannot be arranged without this information.

Prior to requesting service, please consult the Trouble-shooting checklist that is printed in the manual

- All electric motors, including fans, make some noise and may feel hot to touch – this is not a fault.
- Some fans wobble more than others – even the same model.
- Blades are weighed to be within tolerance to minimize wobbling. In multiple installations do not mix blades from fans.
- Finish to the fan, including blades and light complete models, are covered by 2 Years warranty.
- Blade replacements are not covered.



# CEILING FAN WARRANTY DETAIL

Retain AND Fill this form and keep it for your personal records and warranty purposes

NAME.....

ADDRESS.....

.....POSTCODE.....

MODEL NUMBER.....

PO NUMBER or DATECODE ..... (PO# or DATECODE Sticker here)

DATE OF PURCHASE.....

INSTALLING LICENSED ELECTRICIAN.....

.....

LICENCE No.....

ATTACH PROOF OF PURCHASE HERE

IN THE EVENT OF A PRODUCT FAULT, PLEASE ENSURE ALL DETAILS ARE COMPLETED ABOVE.