

CEILING FAN MANUAL

- INSTALLATION
- OPERATION
- MAINTENANCE
- WARRANTY INFORMATION

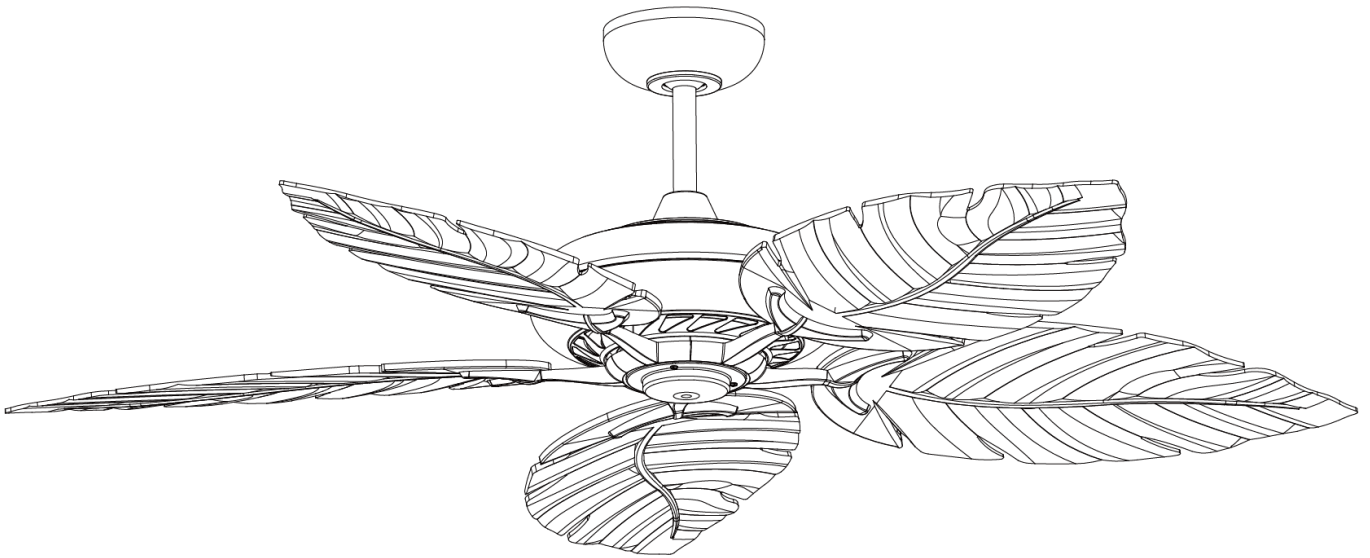

CEILING FAN# 2533

CAUTION

**READ INSTRUCTIONS CAREFULLY FOR SAFE
INSTALLATION AND FAN OPERATION.**

CONGRATULATIONS ON YOUR CHOICE

CONGRATULATIONS, as you have just chosen a good quality ceiling fan. The ECO outdoor ceiling fans are damp rated and are suitable for exterior undercover use.

SAFETY PRECAUTIONS

The information contained in the following pages has been prepared to ensure you of trouble-free operation of your Ceiling Fan .

This appliance is not intended for use by persons (including children) with reduced physical, sensory or mental capabilities, or lack of experience and knowledge, unless they have been given supervision or instruction concerning the use of the appliance by a person responsible for their safety.

Children should be supervised to ensure that they do not play with the appliance.

1. To ensure the success of the installation be sure to read the instructions and study the diagrams thoroughly.
2. For your safety, all electrical connections and disconnections must be performed by a Licensed Electrician.
3. All electrical work should only be undertaken after disconnection of the power by removing fuses or turning off the circuit breaker to ensure all pole isolation of the electrical supply. If you are in any doubt the services of a qualified electrician should be sought to ensure that all work is carried out in accordance with the local regulations, current good practices and other national and local electrical codes.
4. Make sure that your installation location will not allow the rotating fan blades to come into contact with any object and that there is a minimum clearance of 30cm from the blade tip to the wall or nearest object. Please note that the bigger this clearance is the better the airflow from your fan will be. Ensure the blades are mounted at a minimum height of 2.3 meters from the floor when the fan is installed.
5. The fixing point for the fan must be able to support a weight of at least 40kg. If you are mounting the fan to a ceiling junction box, the box and its fixing must be able to support the moving weight of the fan and must not twist or work loose.
6. The fan must be earthed.
7. Do not connect the fan motor to a dimmer switch or solid state controller. This may give an unsatisfactory performance (motor hum) and cause damage to the motor. Only use the supplied remote controller.
8. It is not recommended that ceiling fans and gas appliances be operated in the same room at the same time.
9. The fan must be turned off and stopped completely before reversing the fan direction. This will prevent any damage to the motor of the unit or controller (if installed).
10. Do not insert anything into the fan blades while the fan is operating, as this may cause a person injury, damage the blades, and upset the balance of the unit causing the unit to wobble.
11. After the fan is completely installed make sure that all connections are secured and tightened to prevent any problems.
12. Because of the fan's natural movement, some connections may loosen. Check the support connections, brackets, and blade attachments twice a year to make sure they are all secured. If they are loose, tighten with a screwdriver.

Note: The important safeguards and instructions given in this manual are not meant to cover all possible conditions and situations that may occur. It must be understood that common sense, caution and care are factors, which cannot be built into any product. The persons caring for and using the unit must supply these factors.

For installation advice, please consult a licensed electrician. In the unlikely event of damaged or missing parts please contact the Zebbies Store in which it was purchased or your nearest Zebbies store for assistance.

IMPORTANT NOTES

FAN CONTROL

Your warranty will be invalid if a solid-state dimmer type fan controller or other brand remote controller is used. ONLY use the remote controller supplied.

With these controllers there is a strong possibility that the ceiling fan motor will produce an unpleasant load humming noise.

FAN INSTALLATION

Under our warranty terms, this ceiling fan must be installed by a licensed electrician. Improperly installed ceiling fans can be dangerous and expensive to repair. This will void your warranty too.

FAULT FINDER

Always check the “Trouble Shooting Checklist” included in this booklet before calling for service. Unnecessary calls are inconvenient for all and can attract a service charge.

MECHANICAL NOISE MAY BE NOTICED ON INSTALLATION-ALLOW AT LEAST 8 HOURS SETTling-IN PERIOD. SOME FANS WOBBLE MORE THAN OTHERS—EVEN IN THE SAME MODEL, IT DOES NOT MEAN THE FAN IS FAULTY.

WARNING

This appliance is not intended for use by persons (including children) with reduced physical, sensory, or mental capabilities, or lack of experience and knowledge, unless they have been given supervision or instruction concerning use of the appliance by a person responsible for their safety.

Children should be supervised to ensure that they do not play with the appliance.

The fan must be installed so that the blades are at least 2.3 meters above the floor.

BEFORE INSTALLATION

Unpack your ceiling fan carefully. Remove all parts and hardware. Place fan motor on a cloth or soft surface to avoid damaging the finish.

Do not lay motor housing on its side – as the decorative housing may become bent or damaged.

Verify that all parts are present before starting assembly.

Check the packaging carefully for missing parts.

Examine all parts. You should have the following:

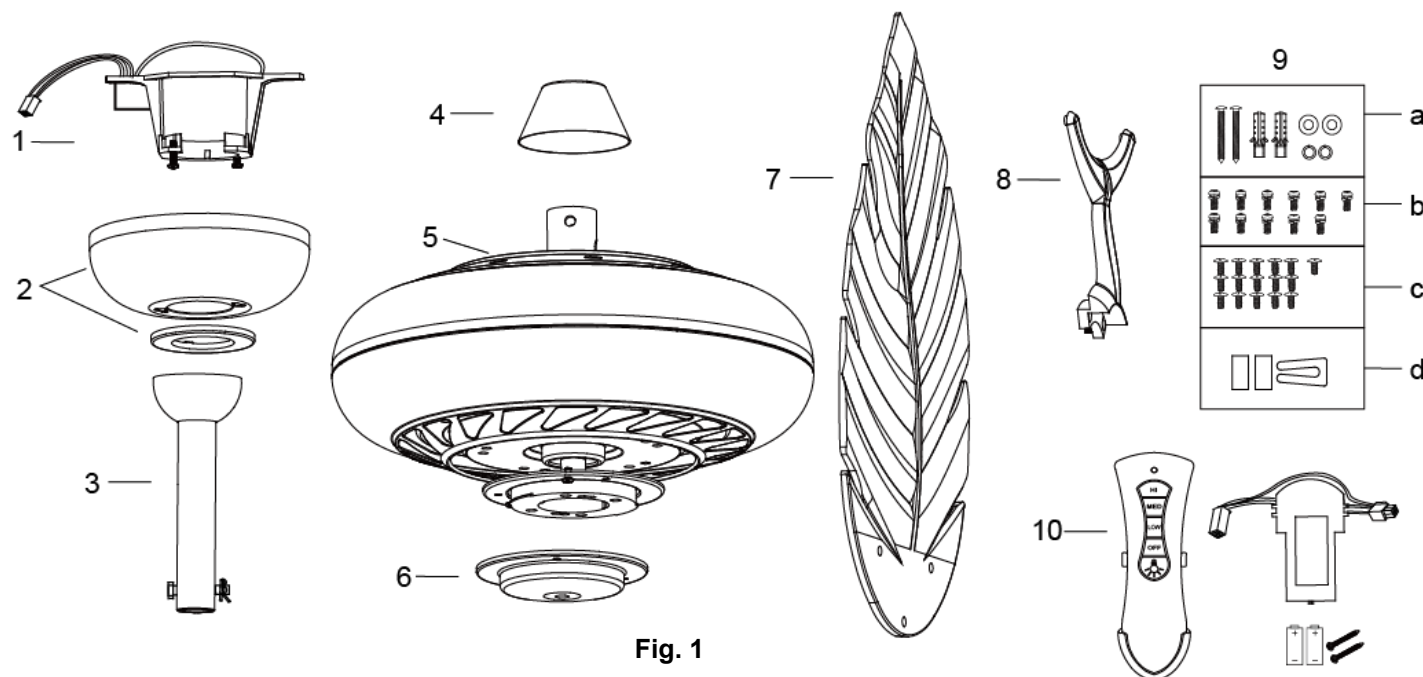

Fig. 1

Fig.1

- 1 Mounting bracket x 1
- 2 Canopy set x 1
- 3 Down rod x 1
- 4 Coupling cover x 1
- 5 Motor assembly x 1
- 6 Bottom cover x 1
- 7 Blades x 5
- 8 Blades bracket x 5

- 9 Screws accessory sets
 - a. Machine screws x 2 Plastic anchor x 2
 - Flat washer x 2 Star washer x 2
 - b. Blades bracket screws x 11
 - c. Blades screws x 16
 - d. Balance kit x 1 set
- 10 Remote control x 1 set

10

INSTALLATION INSTRUCTION

MOUNTING BRACKET INSTALLATION:

- The ceiling fan must be installed in a location so that the blades are 300mm spacing from the tip of the blade to the nearest objects or walls.
- Secure the mounting bracket to the ceiling joist or structure that is capable of carrying a load of at least 40KG, with two plastic anchor, flat washer, star washer and machine screws provided. Ensure at least 30mm of the screw is threaded into the support.

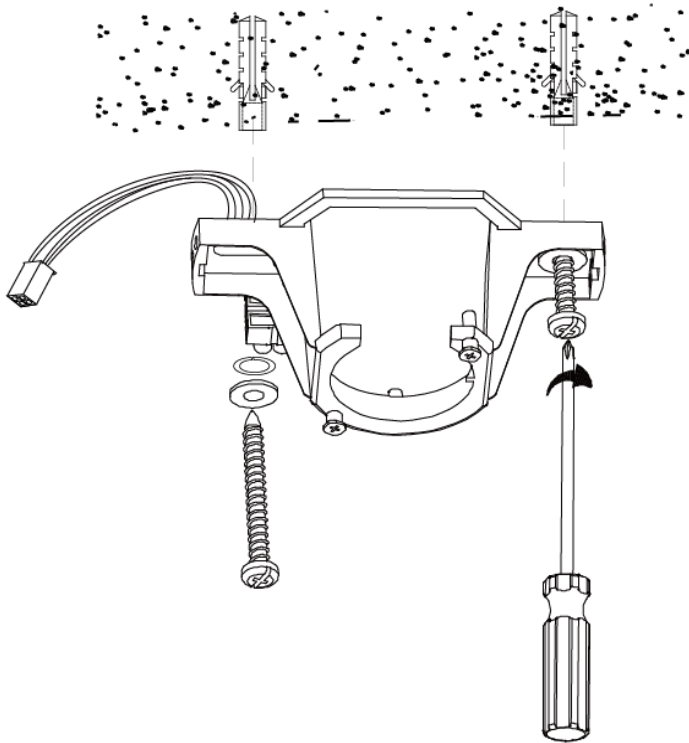

Fig. 2

NOTE: The bracket screws provided are for use with wooden structures only. For structures other than wood, the appropriate screw type **MUST** be used.

PREPARE AND COMPLETE THE ELECTRICAL WIRING --- WIRING DIAGRAM (FIG. 3)

WIRING

For your safety, all electrical connections must be undertaken by a licensed electrician.

1. Connect the mains supply wire to the terminal block. Ensure the wires are secure and no bare wires are exposed.
 - Connect main supply Live wire to “L” (BROWN WIRE)
 - Connect main supply Neutral wire to “N” (BLUE WIRE)
 - Connect Earth wire to “⊕” (GREEN-YELLOW WIRE).

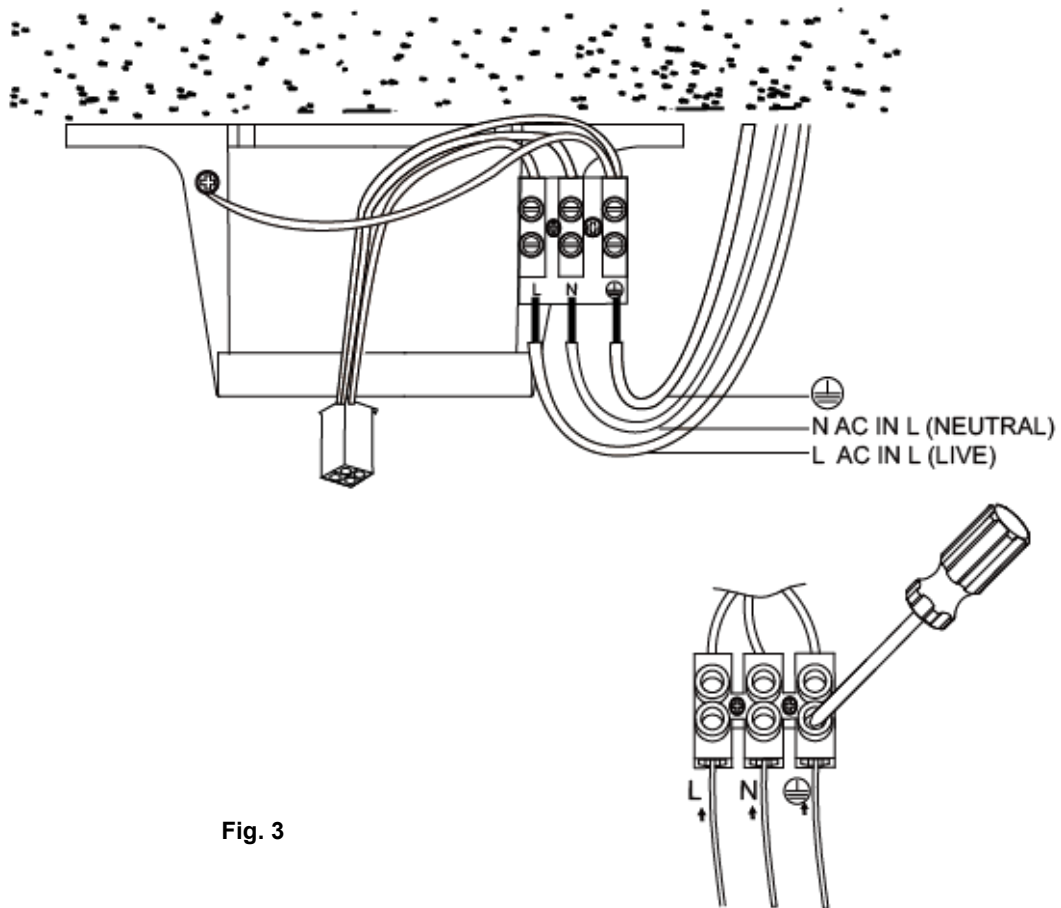

Fig. 3

NOTE:

AN ADDITIONAL ALL POLE DISCONNECTION SWITCH MUST BE INCLUDED IN THE FIXED WIRING. PLEASE MAKE SURE THE MAIN SWITCH HAS BEEN TURNED OFF BEFORE CONNECTING.

2. Remove the R pin & bolt, loose the top joint ball from the down rod

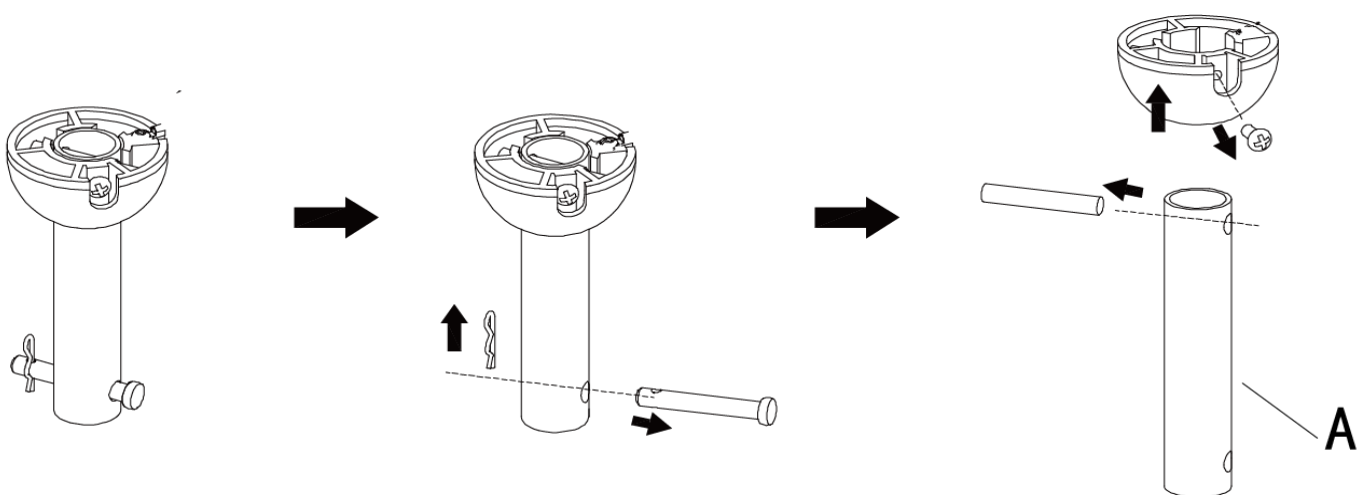

Fig. 4

3. Loosening two screws on joint ball, inserting the down rod to the motor by aligning the holes, with the bolt

and R pin to secure, and reposition and tighten two screws. Attached the coupling and canopy set through the down rod, and tighten by the joint. (Refer to A & B)

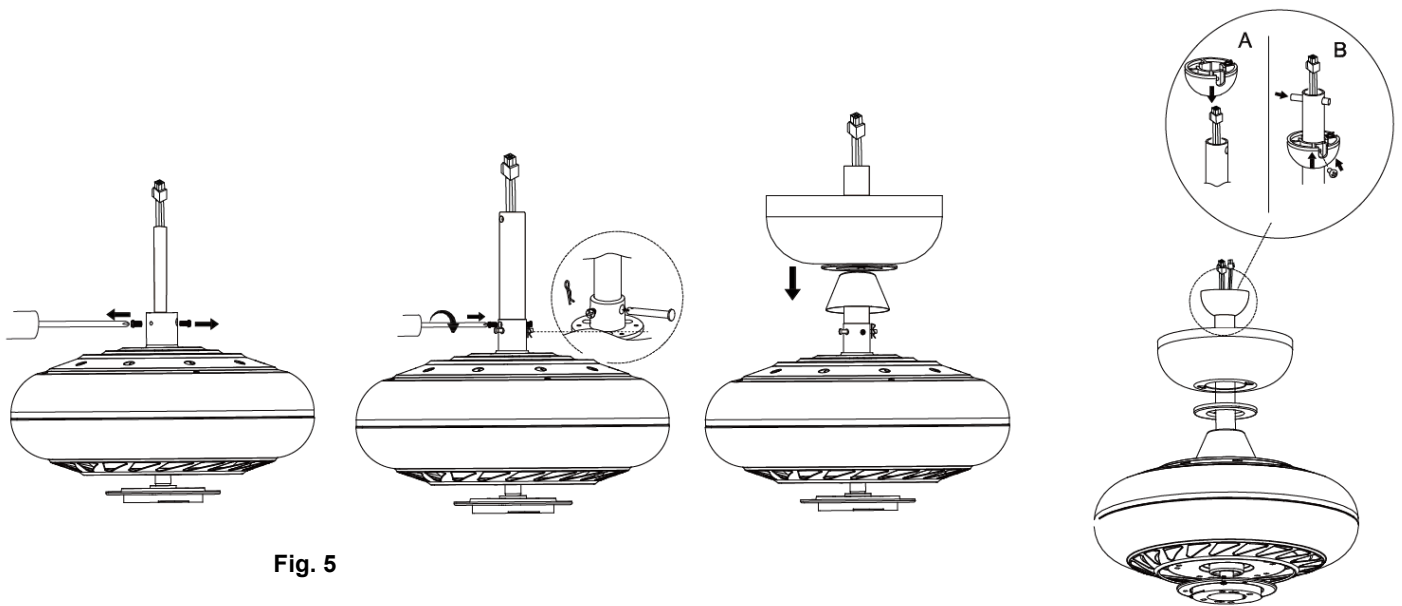

Fig. 5

HANGING THE FAN MOTOR ASSEMBLY

- Lift the fan assembly onto the mounting bracket. Fig. 6
- Ensure the notch of the ball joint is positioned on the stopper of the mounting bracket to prevent the fan from rotating when in operation. Fig. 7

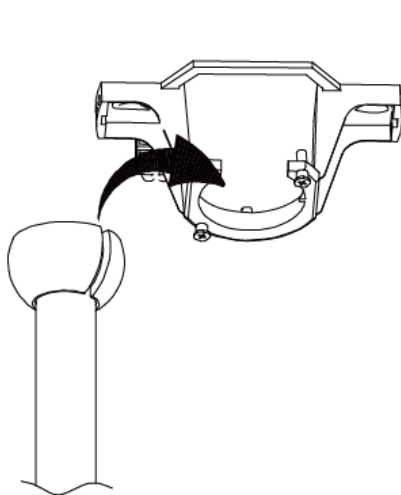

Fig. 6

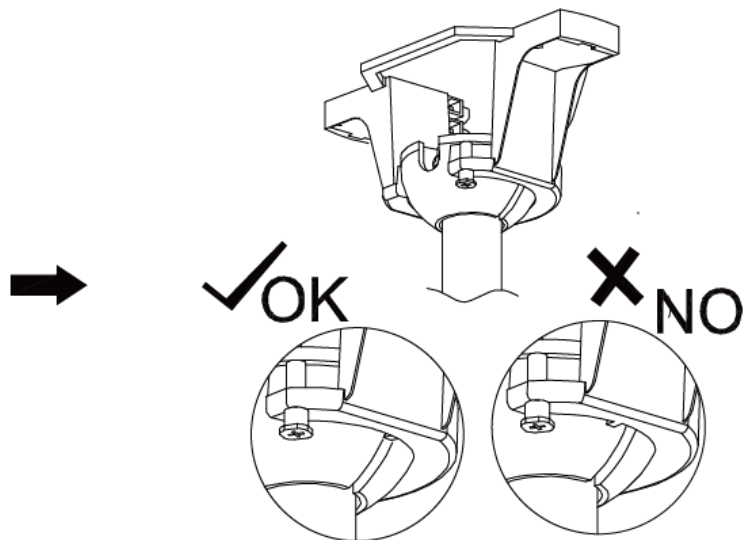

Fig. 7

PREPARE AND COMPLETE THE ELECTRICAL WIRING --- WIRING DIAGRAM (FIG.8)

WIRING

For your safety, all electrical connections must be undertaken by a licensed electrician.

The wiring can now be installed ready for connection to the Receiver.

Wiring requirement when connecting to remote receiver:

- Connect main supply Live wire to "L" (BROWN WIRE)
- Connect main supply Neutral wire to "N" (BLUE WIRE)
- Connect Earth wire to "E" (GREEN-YELLOW WIRE).

NOTE:

AN ADDITIONAL ALL POLE DISCONNECTION SWITCH MUST BE INCLUDED IN THE FIXED WIRING. PLEASE MAKE SURE THE MAIN SWITCH HAS BEEN TURNED OFF BEFORE CONNECTING.

NOTE:

AN ISOLATION SWITCH SHOULD BE INSTALLED SOMEWHERE IN THE FIXED WIRING OF A REMOTE FAN IN CASE REMOTE IS LOST, OR FOR SERVICING OF THE FAN.

NOTE:

REMOTE FANS CANNOT BE CONTROLLED BY A SPEED WALL SWITCH OR LIGHT WALL SWITCH.

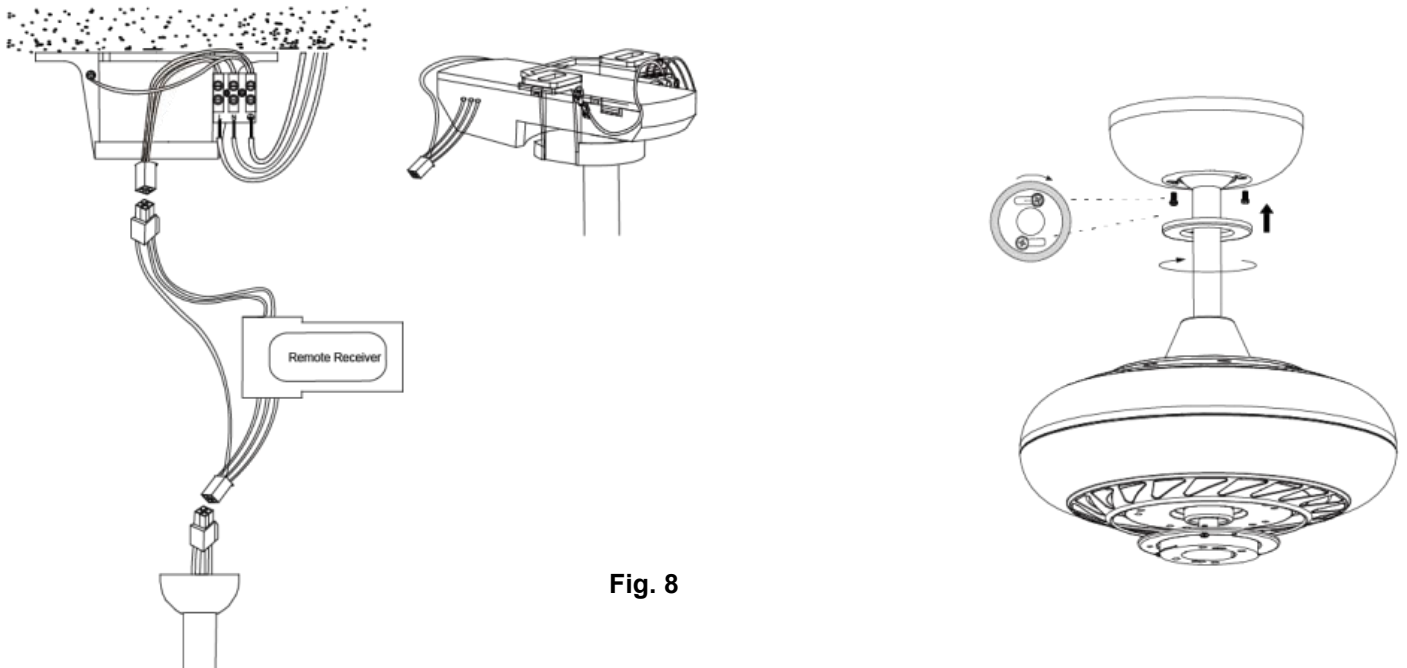

Fig. 8

INSTALL CANOPY COVER

- Place the remote receiver to the mounting bracket after wiring,
- Align the holes on the canopy with the holes on mounting bracket and secure by tightening the two screws. Avoid damaging the electrical wiring prepared previously. Clockwise rotate the decorative cap of canopy and slide into the slot hole until tight.

BLADE INSTALLATION

- Use 3 blade screws to secure each blades and blade bracket until tight. Fig.8

- Then secure the blade to the motor by tightening the 2 screws.
- Repeat this process to install the other blades to the motor.

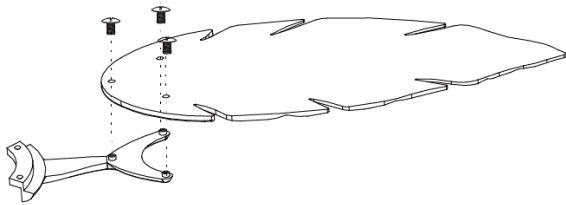

Fig. 8

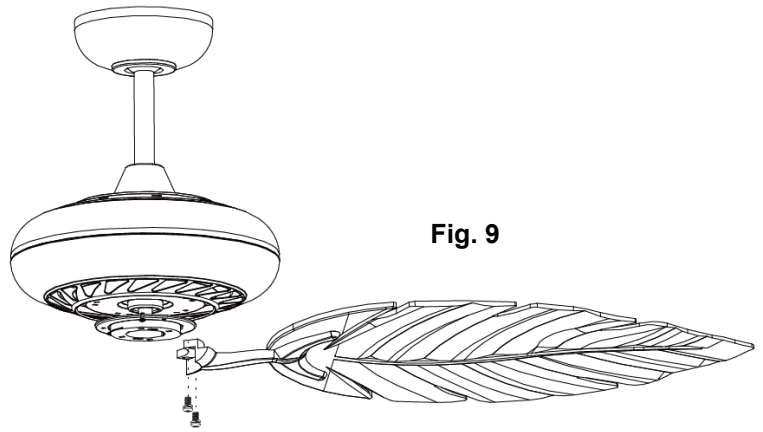

Fig. 9

- Finally install the bottom cover to the motor shaft by tightening the 3 screws. Fig. 10

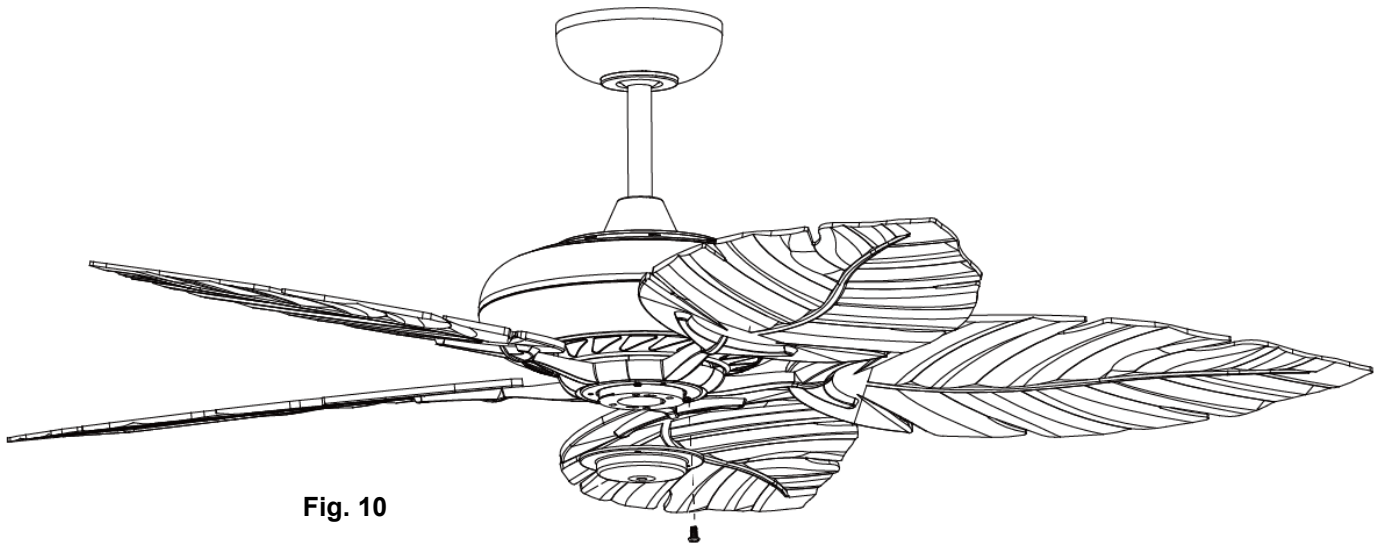
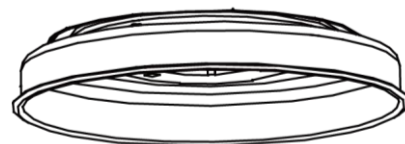
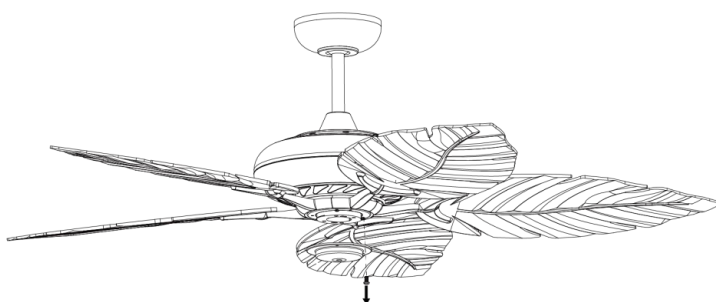

Fig. 10

NOTE: The light switch wiring diagram is omitted for models that do not have the light feature

OPTIONAL TO INSTALL A LIGHT KIT (COMPATIBLE WITH CODE 1432)

Loose three screws at the bottom cover of motor (1 screw should be remove off)



← 1.light kit



← 2.GX53 Lamp
3839 & 3864

Align the holes of light kit and the holes on the bottom of motor housing cover, slide the light kit clockwise with 3 screws to secure.

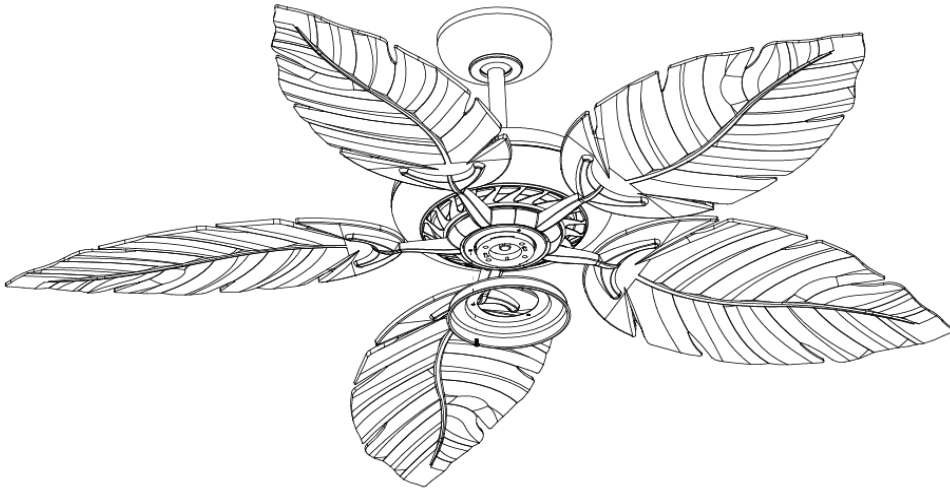

Install the GX53 Lamp to the light kit (Recommend the code 3839 & 3864)

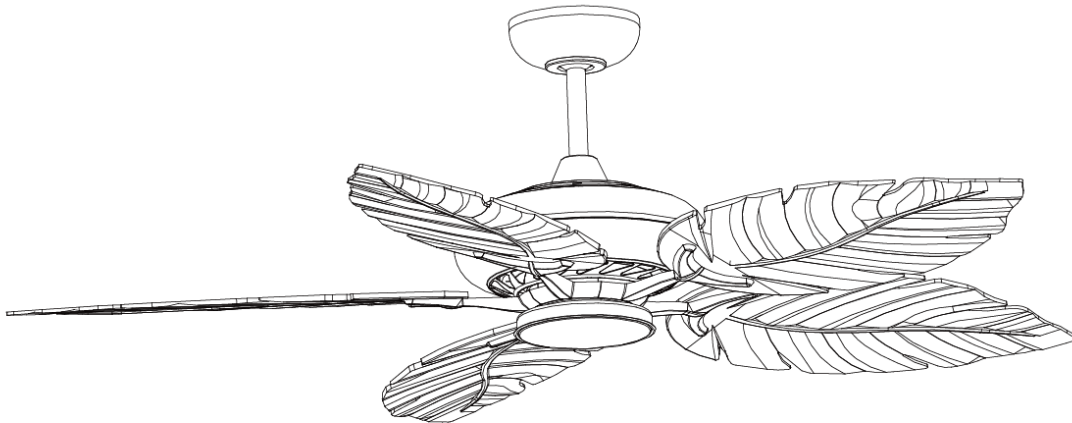
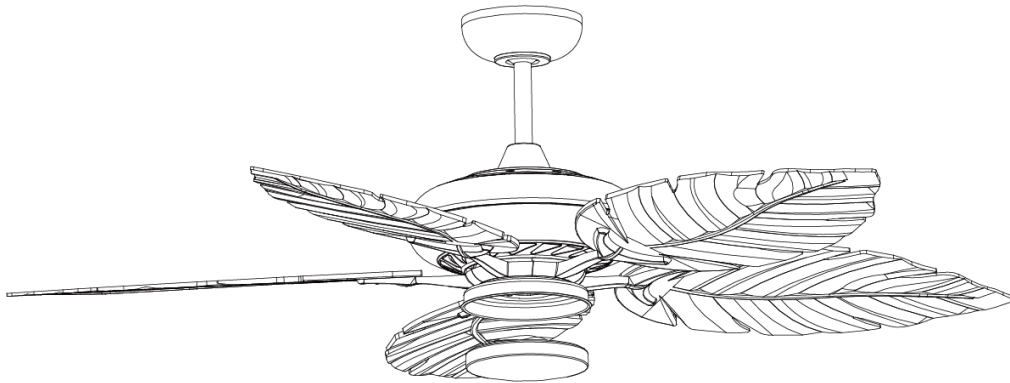

REMOTE CONTROL OPERATING INSTRUCTION

This ceiling fan remote control is only suitable for controlling the fan motor and the light kit associated with the ceiling fan. Any other use would be considered as misuse and warranty would be invalid. □ Do not use a solid state dimmer with this ceiling fan remote controller.



Receiver (controller)



Transmitter (remote)

This remote control is designed to control your ceiling fan speed and light. (Fig 10)

Installation preparation

Before carrying out the installation, the following must be considered.

- 2 x AAA 1.5V (size) batteries are required to operate the remote control. Remove the battery cover from the back of the remote and insert 2 x AAA batteries. Ensure the polarities are correct as shown in the battery compartment. And that the batteries are all fresh batteries (batteries are not included).
- The transmitter and receiver must be configured so that communication between each other is paired up. This is achieved by setting the DIP switch on the receiver and transmitter on the same setting.

Note:

The DIP switch assembly has 4 switches which can be setup to 16 different transmitting code combinations. This is practical when there is more than 1 remote/receiver pair operating locally or in the same room.

Note:

To access the receiver DIP switches, remove the DIP switch cover.

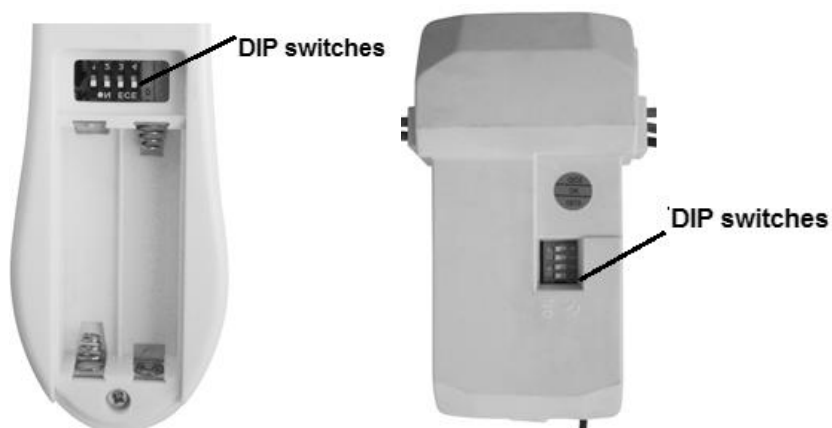

Fig. 11 Remote battery compartment

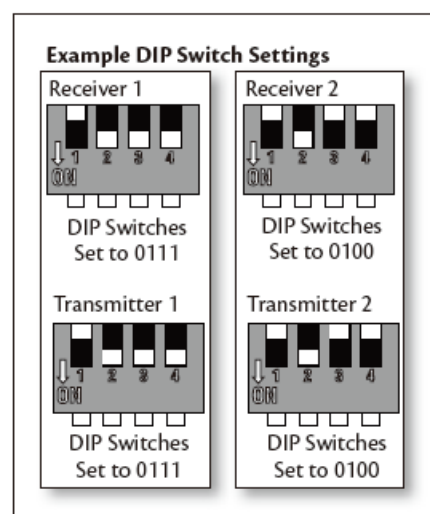

Fig. 12 Receiver DIP switch

INSTALLATION DIRECTIONS:

WARNING – HIGH VOLTAGE

BEFORE CONNECTING THE RECEIVER & CHANGING CODES

- **For your safety: Power to the circuit must be disconnected or SWITCHED OFF.**
- **Household power can cause SERIOUS INJURY or DEATH.**
- **Wiring must meet all local and National Electrical wiring codes.**

MAKING THE ELECTRICAL CONNECTIONS (see Fig. 8)

Use the wire nut terminal block provided for making connections.

1. Disconnect electrical power from the working circuit.
2. Remove the ceiling fan CANOPY cover from the mounting bracket.
3. Disconnect existing wiring from the supply at ceiling.
4. Connect the earth (GREEN/YELLOW) wire to the supply EARTH wire, and ensure continuity for the whole electrical earth wiring.
5. Connect **AC IN L** of control unit to **AC L** supply wire.
6. Connect **AC IN N** of control unit to **AC N** supply wire.
7. Connect **TO MOTOR N** of control unit wire to the **MOTOR (N)** fan wire.
8. Connect **TO MOTOR L** of control unit wire to the **MOTOR (L)** fan wire.
9. Connect **FOR LIGHT** of control unit wire to the **LIGHT (L1)** fan wire.
10. Push the connected wires up into the junction box.
11. Lay the control unit wire on top of the control unit.
12. Lay the control unit in the CANOPY. (See Fig. 6).
13. Reinstall the canopy on the mounting bracket.
14. Restore electrical power to the circuit.

Operating the remote

Before you start using the remote, take the time to read through this section and get familiar with the function of each button.



Fig. 13

LED Indicator: The red LED indicator on the top of transmitter will flash when the buttons are active.

HI: Press the button to set fan running speed to high.

MED: Press the button to set fan running speed to medium.

LOW: Press the button to set fan running speed to low.

OFF: Press the button to turn OFF the fan.



:Press the button to turn ON/ OFF the light.

The remote has a memory function. If the fan or light is turned off by the wall switch, it will memories and recover the last status when turned on next.

AFTER INSTALLATION

WOBBLE:

Note: Ceiling fans tend to move during operation due to the fact that they are mounted on a rubber grommet. If the fan is mounted rigidly to the ceiling it would cause excessive vibration. Movement of a few centimeters is quite acceptable and does not suggest any problem.

TO REDUCE THE FAN WOBBLE:

Please check that all screws which fix the mounting bracket and down rod are secure.

BALANCING KIT:

A balancing kit is provided to balance the ceiling fan on initial installation. Please refer to the instruction on how to use the balancing kit. The balancing kit can be used to assist re-balancing should the ceiling fan become un-balanced again. Store your balancing kit away after installation for future use, if required.

NOISE:

When it is quiet (especially at night) you may hear occasional small noises. Slight power fluctuations and frequency signals superimposed in the electricity for off-peak hot water control, may cause a change in fan motor noise.

This is normal. Please allow a 24-hour “settling-in” period, most noises associated with a new fan disappear during this time.

The manufacturer’s warranty covers actual faults that may develop and NOT minor complaints such as hearing the motor run – all electric motors are audible to some extent.

CARE & CLEANING

- Periodic cleaning of your ceiling fan is the only maintenance required. Use a soft brush or lint free cloth to avoid scratching the paint finish. Please turn off electricity power when you do so.
- **Do not** use water when cleaning your ceiling fan. It could damage the motor or the blades and create the possibility of an electrical shock.
- The motor has a permanently lubricated ball bearing. There is no need to oil.

NOTE:

Always turn off the power at the mains switch before attempting to clean your fan.

TECHNICAL INFORMATION

| Ceiling Fan model | Finish | Rated Voltage | Rated power (motor) | Battery for remote |
|-------------------|--------|---------------|---------------------|--------------------|
| 2533 | White | 220-240VAC | 80W | 2 x 1.5VAAA |

WARNING

- *The fan must be installed so that the blades are more than 2.3 meters above the floor.*
- *All electrical connections must be installed by a licensed electrician. This ceiling fan is within this requirement*
- *According to our warranty terms, only faulty fans installed by licensed electrician will be covered by a service warranty.*

TROUBLE-SHOOTING CHECKLIST

| TROUBLE | PROBABLE CAUSES | SUGGESTED REMEDY |
|---|---|---|
| 1. Fan will not start (Warning: THE ceiling fan must be switched OFF, and the assistance of a licensed electrician maybe required.) | A. Fuse or circuit breaker blown. | Check main and branch circuit fuses or circuit breakers. |
| | B. Loose power line connections to the fan. | Check line wire connections to fan |
| | C. Speed controller not in correct position. | Check speed controller's position. |
| 2. Fan Wobbles (Refer to Wobble section of the manual for further information.) | A. Fan blades are not horizontal to ceiling. | Refer to "BALANCING/WOBBLING TROUBLE SHOOTING" section of manual. <ul style="list-style-type: none"> - The blades may require adjustment at the blade mounting screws. - The blades are out of shape, thus causing wobbling. New set of blades will be required. Contact your local Zebbies Lighting store. |
| | B. Blade screws are loose. | Make sure all screws are securely fastened. |
| | C. Blade/s are out of shape | Remove blade and lay on a flat surface to check if blades are out-of-shape. Contact Zebbies Lighting for replacement blades. |
| 3. Fan sound noisy | A. Top canopy touching ceiling. | Lower Canopy from ceiling to ensure minimum 3 mm clearance. |
| | B. Loose fan blade screws. | Re-tighten all screws on fan blades but never over-tighten. |
| | C. Ceiling fan not secured against | Re-tighten all screws in the hanging bracket or |

| | | |
|---------------------|---|--|
| | ceiling. | plate. |
| | D. Incorrect speed controller. | Change the controller to the one supplied. |
| 4. Mechanical Noise | A. Allow at least for 8 hours settling-in period. | |

WARNING: THE CEILING FAN MUST BE SWITCHED OFF, BEFORE TROUBLE SHOOTING IS PERFORMED.

WARRANTY CONDITIONS

This product is guaranteed against electrical defects in material or manufacturing workmanship for faults when under normal domestic/residential conditions for a certain period from the date of purchase. This warranty covers parts and labour costs for the motor subject to the following conditions:

1. Installation being performed by a qualified licensed Electrician.

This warranty will not apply if the ceiling fan is installed by anyone other than a licensed electrician. Problems arising from incorrect installation are not covered by the warranty. The cost of repairs and/or service call where the defect is due to the installation and not due to faulty material or workmanship, in accordance with wholesaler and their authorized agent, will be payable at time of repair.

2. The correct controller must be fitted to the fan.

Only use the controller supplied with the fan or a genuine replacement. Using solid-state dimmer type or non-genuine controllers will void the warranty. The use of non-genuine controllers may cause the fan to operate with a loud hum and at an altered speed. Where controllers are supplied complete with light switch, do not use this switch to operate the fan. Fans connected using this switch to turn the fan on/off, will not be covered by the warranty.

3. Repair work being carried out by a licensed electrician only after authorization by the wholesaler or their authorized agent to complete the repair and is subject to the supply of dated proof of purchase and installing electricians' details.
4. The exclusion of the warranty will be due to any changes to ceiling fan blade or motor, plated and/or painted finishes due to climatic conditions (moisture, salt air etc) or after 6 months from the date of purchase or other circumstances deemed to be beyond the control of wholesaler or their authorized agents.

5. **The warranty service does not cover:**

- a. Transportation and in-transit insurance costs if the product or parts thereof have to be returned for repair or replacement to the retailer or their authorized agent.
- b. Repair of defects caused by accident, fire, misuse, alterations modification, negligence, incorrect or incomplete installation/operation, any unauthorized person attempting to repair the ceiling fan, or acts of God.
- c. Claims or damage to furniture, carpet, wall, ceiling foundations or any other consequential loss either direct or indirectly resulting from a faulty ceiling fan.

6. The warranty applies to actual faults which may develop. Minor running noises are not covered. All electrical motors have some audible noise. Allow at least eight hours of operation to allow the bearings to properly seat. the fan, especially when set on low, may feel warm to touch – this is not a fault. If excessive heat is generated a service call may be required. Fan noises can vary due to slight power fluctuations and mains frequency signals for off – peak-controlled appliances. These changes are most noticeable in the quiet of night, mains frequency signals which come across as an intermittent hum (mostly at night) are out of the control of the manufacturer, in these cases your electricity provider should be contacted, or an electrician to fit a suitable noise filter.
7. Threaded components such as blade nuts can work slightly loose during normal operation. These should be tightened regularly to ensure that the fan does not develop operation noises. If noises do develop, check this aspect before requesting service. This is not covered by the warranty.
8. Minor variation of speed may be evident between different fans, even in the same model and is not a product fault and not covered by the warranty.
9. Blades are not covered by the warranty against defect in material. The replacement of the blades is not covered by the warranty service, notification within 48 hours of installation is required where blades have found to be broken on unpacking, contact the retailer who will send you a new set of blades. Each blade set is balanced, so it is important to replace all blades. Blades affected by climatic conditions and by maintenance are not covered by this warranty.

For under warranty service, contact the hotline number in this booklet and advise: the model number and style, the nature of the fault, date, and place of purchase. Service cannot be arranged without this information.

Prior to requesting service, please consult the Trouble-shooting checklist that is printed in the manual

- **All electric motors, including fans, make some noise and may feel hot to touch – this is not a fault.**
- **Some fans wobble more than others – even the same model.**
- **Blades are weighed to be within tolerance to minimize wobbling. In multiple installations do not mix blades from fans.**
- **Finish to the complete fan is covered by 1 Years warranty.**
- **Blade replacements are not covered.**

CEILING FAN WARRANTY DETAIL

Retain AND Fill this form and keep it for your personal records and warranty purposes

NAME.....

ADDRESS.....

.....POSTCODE.....

MODEL NUMBER.....

PO NUMBER or DATECODE
(PO# or DATECODE Sticker here)

DATE OF PURCHASE.....

INSTALLING LICENSED ELECTRICIAN.....

.....

LICENCE No.....

ATTACH PROOF OF PURCHASE HERE

IN THE EVENT OF A PRODUCT FAULT, PLEASE ENSURE ALL DETAILS ARE COMPLETED ABOVE.