

# **ZEBBIES CARDINAL 80W AC CEILING FAN**

- **INSTALLATION**
- **OPERATION**
- **MAINTENANCE**
- **WARRANTY INFORMATION**

**CAUTION**  
**READ INSTRUCTIONS CAREFULLY FOR SAFE  
INSTALLATION AND FAN OPERATION.**

# Cardinal Fan Installation Instructions

## THANK YOU FOR PURCHASING

Thank you for purchasing this quality Zebbies product. To ensure correct function and safety, please read and follow all instructions carefully before assembly, installation and use of this ceiling fan. Please keep instructions for future reference.

## SAFETY PRECAUTIONS

1. In South Africa: The appliance is not intended for use by persons (including children) with reduced physical, sensory or mental capabilities, or lack of experience and knowledge, unless they have been given supervision or instruction concerning the use of the appliance by a person responsible for their safety.
2. Children should be supervised to ensure that they do not play with the appliance.
3. An all-pole disconnection switch must be incorporated into the fixed wiring, in accordance with local wiring rules.

### **WARNING:**

#### **FOR SAFE USE OF THIS FAN AN ALL-POLE DISCONNECTION MUST BE INCORPORATED INTO THE FIXED WIRING IN ACCORDANCE WITH THE WIRING RULES.**

Please note warranty will be void if installation is without a means for an all-pole disconnection incorporated in the fixed wiring in accordance with the wiring rules.

Example: If a fan is connected to a circuit that can be isolated via an all-pole safety switch at the switchboard, then this is considered to be an all-pole disconnection to the ceiling fan electrical circuit, meeting the requirements.

**A single-pole switch on the active of the receiver input of the remote control must also be included in the wiring, and be located in the same room as the ceiling fan.**

**This fan is suitable for domestic indoor use only.**



4.  Do not dispose of electrical appliances as unsorted municipal waste, use separate collection facilities. Contact your local government for information regarding the collection systems available. If electrical appliances are disposed of in landfills or dumps, hazardous substances can leak into the ground water and get into the food chain, damaging your health and well-being.
5. The structure to which the fan is to be mounted must be capable of supporting a weight of 30kg.
6. The fan should be mounted so that the blades are at least 2.3 m above the floor.
7. This fan is designed for domestic indoor use only. Mounting the fan in a location where it is subject to water or moisture is dangerous and may increase the risk of damage, injury or electrical shock and will void the warranty.
8. Must be assembled and installed by a licensed electrician.
9. **WARNING:** If unusual wobbling or oscillating movement is observed, immediately stop using the ceiling fan and contact the manufacturer, its service agent or suitably qualified persons.
10. The replacement of parts of the safety suspension system device shall be performed by the manufacturer, its service agent or suitably qualified persons.
11. The fixing means for attachment to the ceiling such as hooks or other devices shall be fixed with a sufficient strength to withstand 4 times the weight of the ceiling fan; that the mounting of the suspension system shall be performed by the manufacturer, its service agent or suitably qualified persons.

# Cardinal Fan Installation Instructions

## PARTS LIST

- Unpack your ceiling fan carefully. Remove all parts and hardware.
- Lay out all the components on a smooth surface and make sure there are no components missing before assembling. If parts are missing, return the complete product to the place of purchase for inspection or replacement.
- Check whether the ceiling fan has been damaged during transport. Do not operate/install any product which appears damaged in any way. Return the complete product to the place of purchase for inspection, repair or replacement.
- Examine all parts, you should have the following:

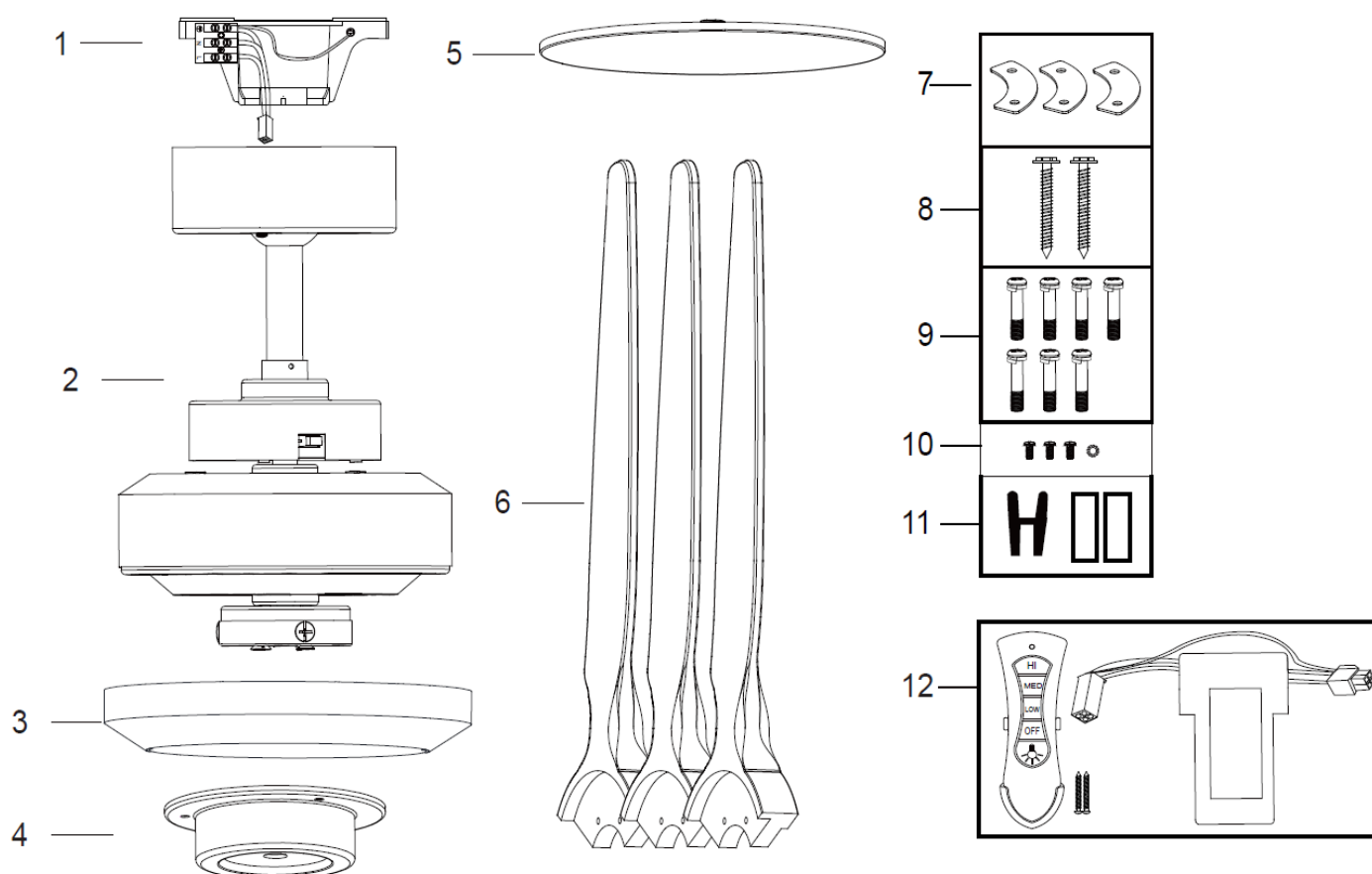

**Fig. 1**

- |   |   |
|---|---|
| 1. Mounting bracket x 1                             | 7. Blade bracket x 3                        |
| 2. Pre-assembled fan motor, down rod and canopy x 1 | 8. Screw for mounting bracket x 2           |
| 3. Light plate x 1                                  | 9. Blade screw x 6 ( and 1 spare)           |
| 4. Connection part                                  | 10. Screws & washer for connection part x 3 |
| 5. Bottom cover x 1                                 | 11. Balancing kit x 1 set                   |
| 6. Blade x 3  | 12. Remote control x 1 set                  |

# Cardinal Fan Installation Instructions

## INSTALLING THE MOUNTING BRACKET

- The ceiling fan must be installed in a location so that the blades are spaced 300mm from the tip of the blade to the nearest objects or walls.
- Install the hanging bracket to the ceiling joist or structure that is capable of carrying a load of at least 30kg, with two long screws provided. Ensure at least 30mm of the screw is threaded into the support. (Fig. 2)

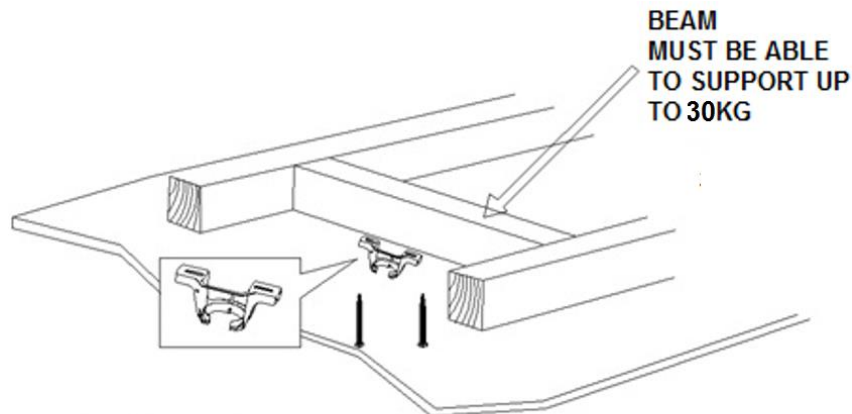

Fig. 2

**NOTE: THIS PICTURE IS FOR REPRESENTATION ONLY AND DOES NOT REPRESENT THE ACTUAL BRACKET.**

**NOTE: The bracket screws provided are for use with wooden structures only. For structures other than wood, the appropriate screw type **MUST** be used. Ensure the screws used are suitable for the mounting surface and the surrounding environment.**

## ANGLED CEILING INSTALLATION

This fan hanging system supports a maximum 15 degree angled ceiling installation. (Fig. 3)

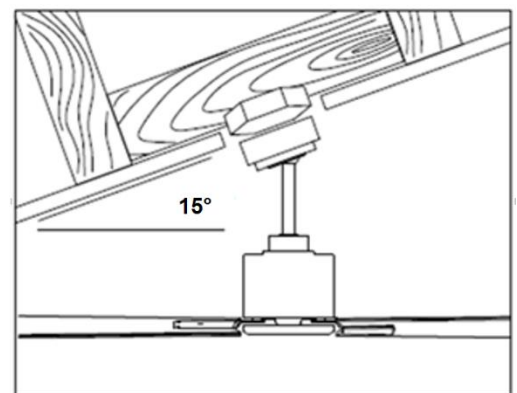

Fig. 3

## HANGING THE FAN

Lift the fan assembly onto the mounting bracket. Ensure the key notch of the hanger ball joint is positioned on the key pin of the mounting bracket to prevent the fan from rotating when in operation. (Fig.4)

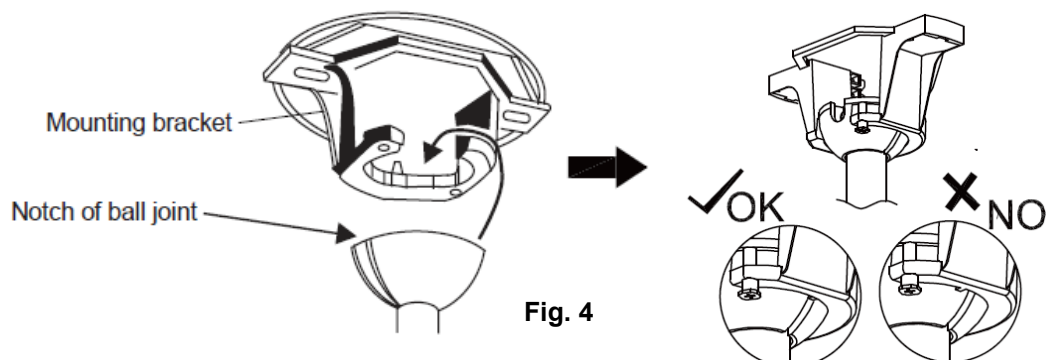
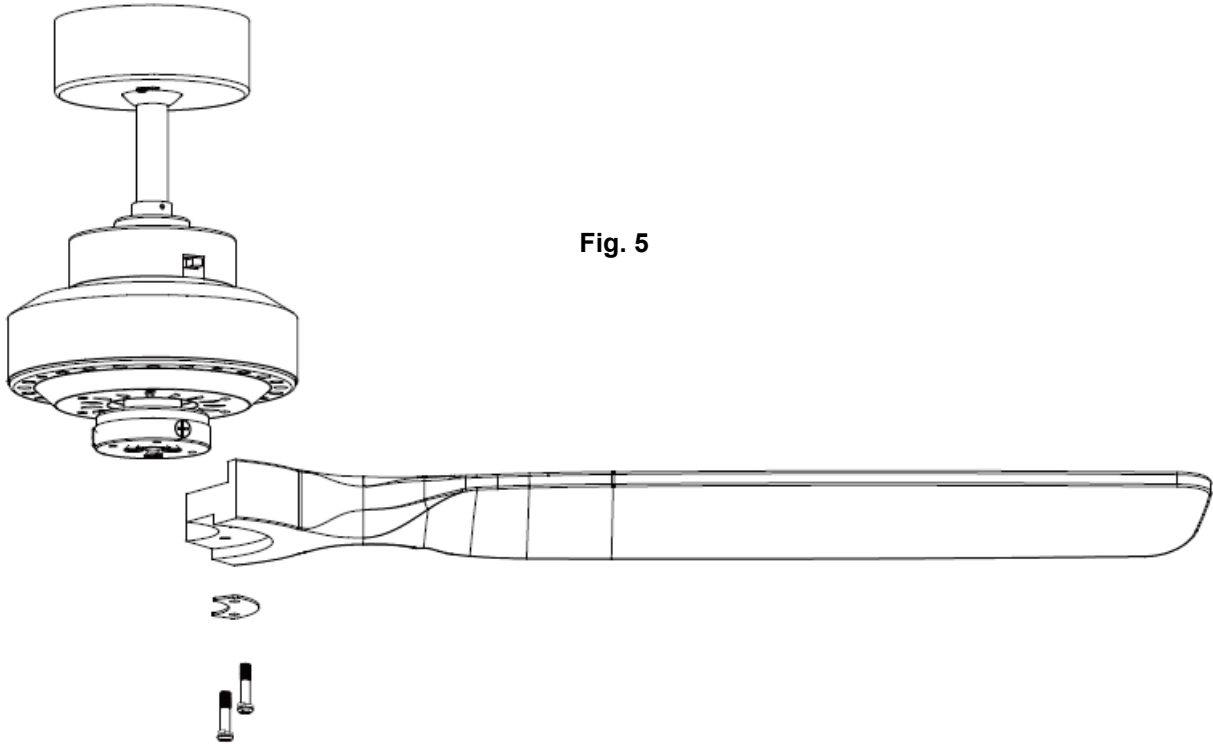

Fig. 4

## INSTALLING THE FAN

### **BLADE ATTACHMENT**

- Insert the blade screws through the blade bracket and place on the underside of the blade. (Fig. 5)
- Align the screws with the holes and secure the blade onto bottom of the fan motor. Ensure the screws are tightened equally and evenly to reduce the chance of warping or unbalancing. Take care not to over tighten the screws as this can damage the blades.
- Repeat the process for the remaining blades.



### **INSTALLING THE BOTTOM COVER (FOR FAN WITHOUT LIGHT)**

- Install the connection part onto the connection box by securing the 3 screws (Fig. 6)
- Install the bottom cover onto the motor shaft by rotating it clockwise. (Fig. 7)

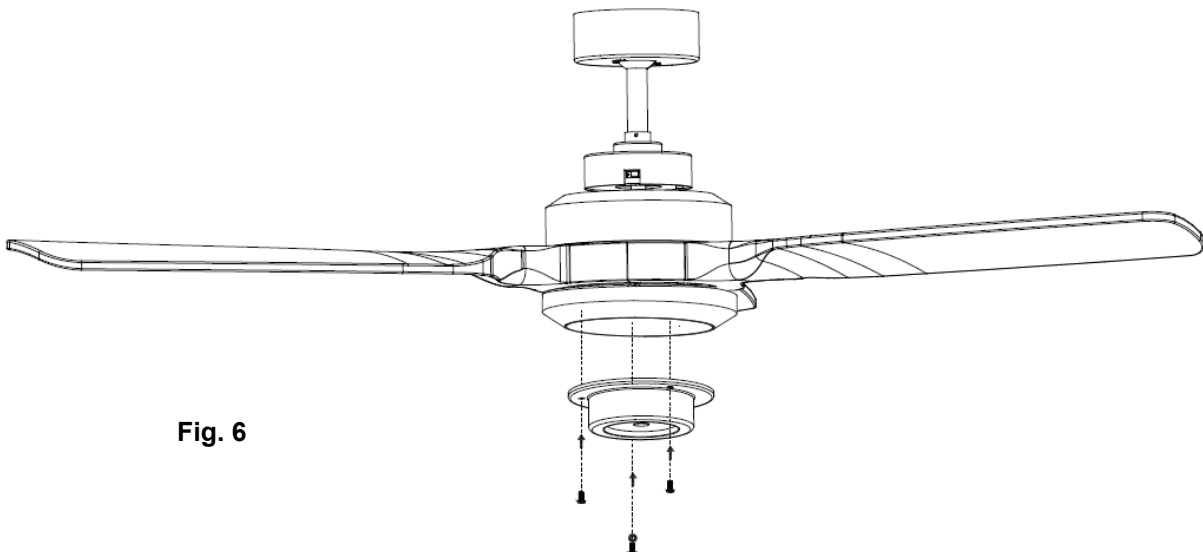

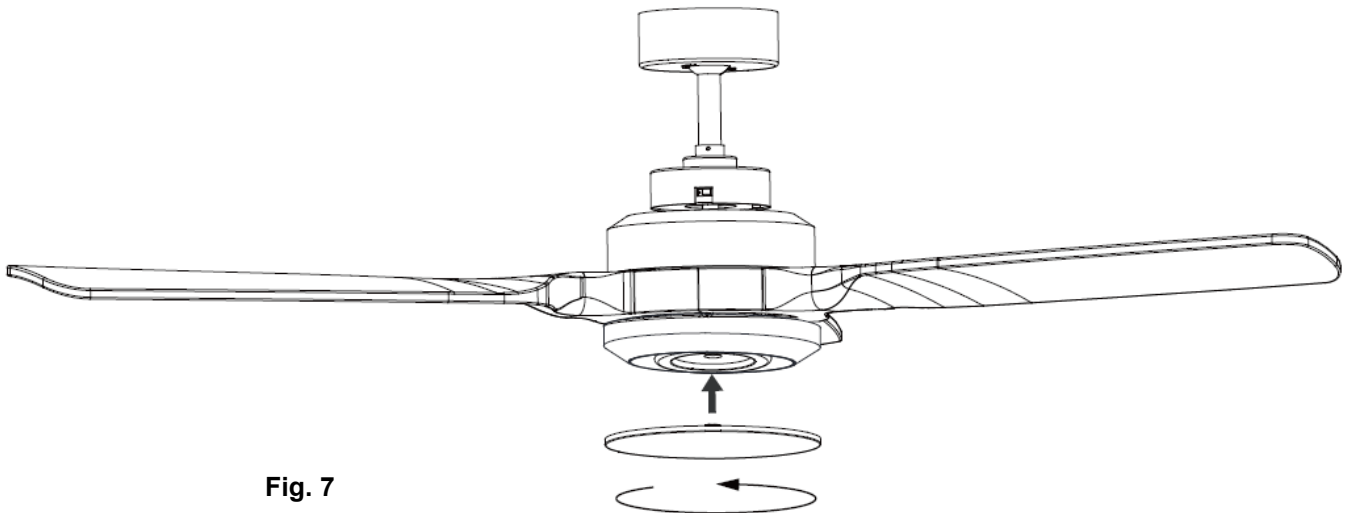

Fig. 7

## **INSTALLING THE LIGHT KIT (FOR FAN WITH LIGHT)**

- Join the connectors together and place into the connection box. Install the light plate onto the connection box by securing the 3 screws (Fig. 8)
- Install the globe (not included) into the lamp holder. (Fig. 9)

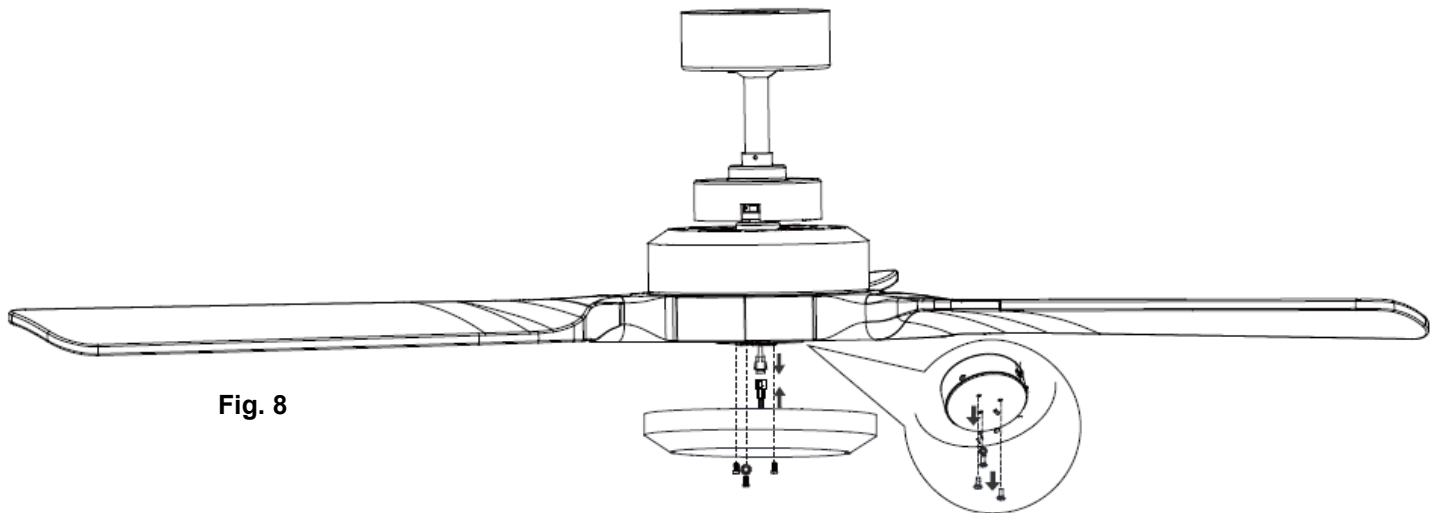

Fig. 8

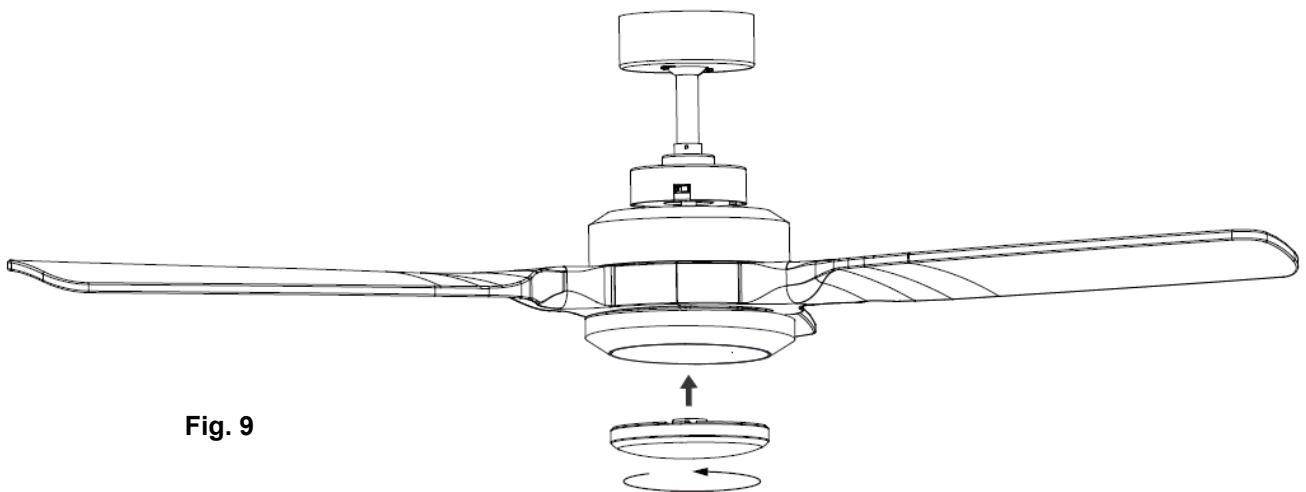

Fig. 9

# Cardinal Fan Installation Instructions

## ELECTRICAL WIRING DIAGRAM

**WARNING:** FOR YOUR SAFETY ALL ELECTRICAL CONNECTIONS MUST BE UNDERTAKEN BY A LICENSED ELECTRICIAN.

**NOTE:** AN ADDITIONAL ALL POLE DISCONNECTION SWITCH MUST BE INCLUDED IN THE FIXED WIRING.

**NOTE:** Wiring diagram includes the light kit wiring. The light wiring diagram and switch is omitted when no light kit is used with the ceiling fan.

Ensure the motor earth wire is connected to the single earthing terminal block, for (Fig.10)

**Remote with quick connectors (using quick connectors)**

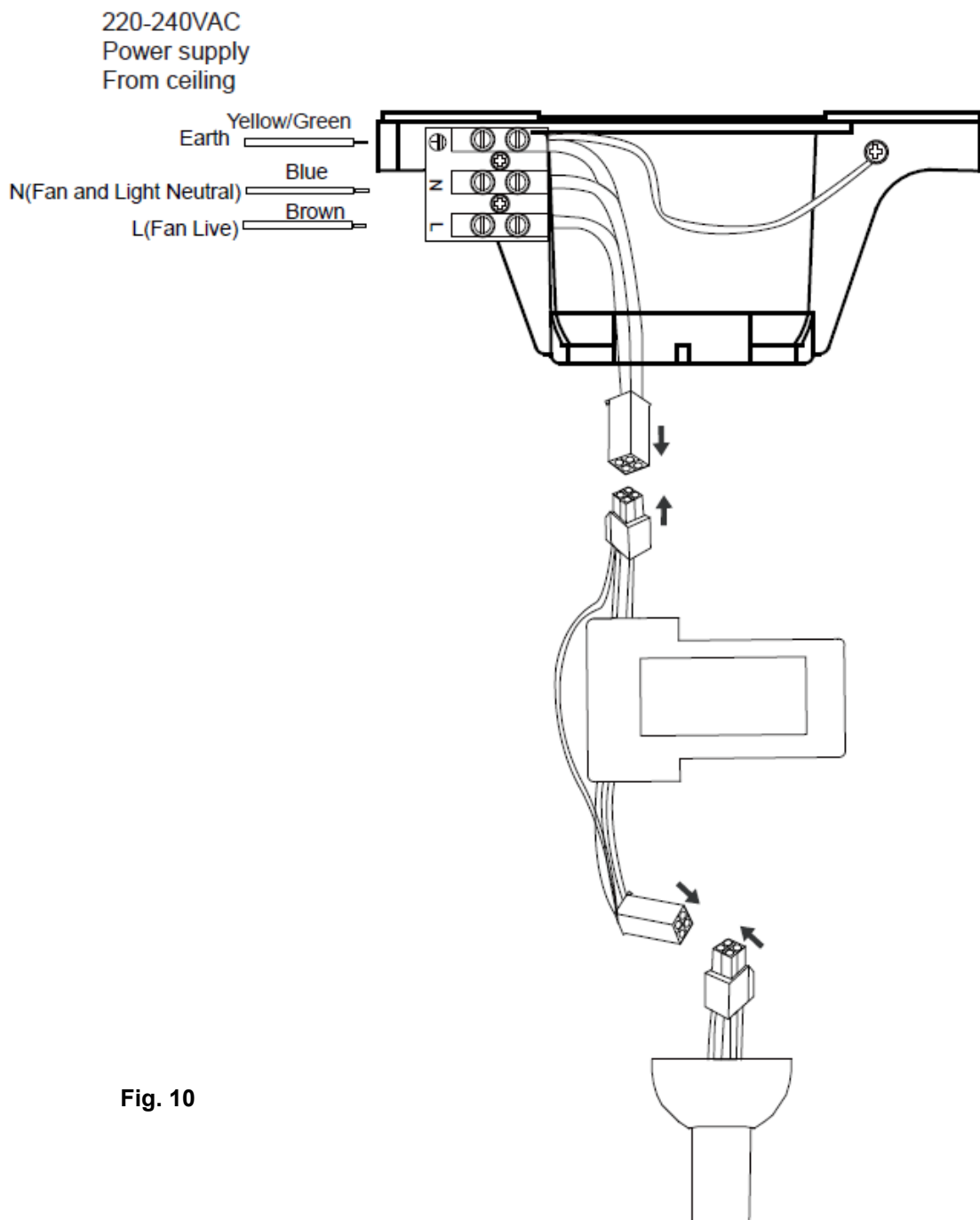

Fig. 10

# Cardinal Fan Installation Instructions

After wiring, carefully lead the wires at sides to avoid damaging the electrical wiring prepared previously, and insert the remote receiver into the top layer of the mounting bracket. (Fig. 11)

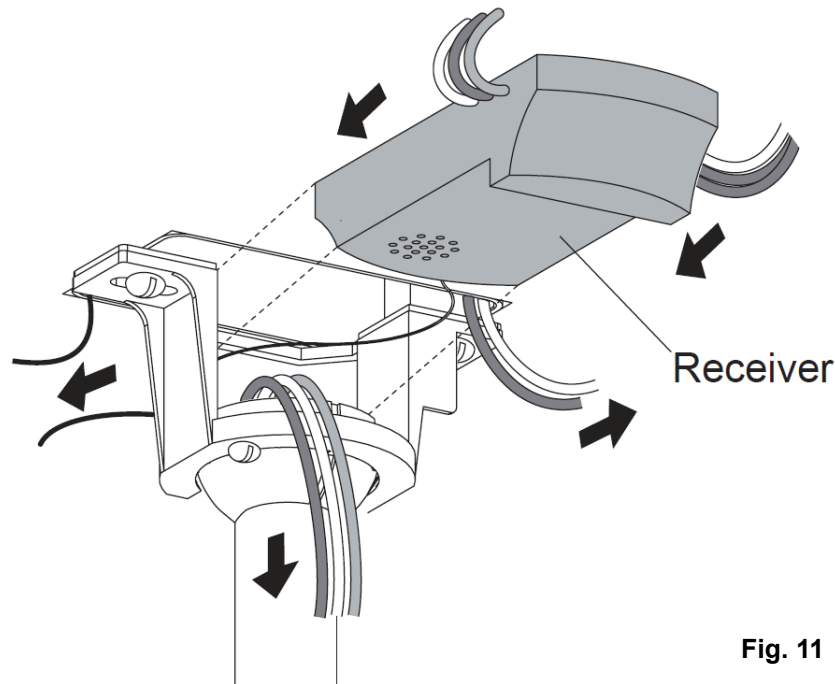

Fig. 11

## FINISHING THE INSTALLATION

- After completing the electrical connection at the mounting bracket terminal block, connect the ceiling fan wiring via the quick connector plug.
- Ensure the earth wiring is secure and correct, by performing an earthing continuity test from the fan's accessible metal body back to the earth terminal at the terminal block on the mounting bracket.
- Cover the mounting bracket with the canopy. Ensure all electrical wiring is tucked inside the canopy and that the wires are not damaged during this step. Secure the canopy to the hanger bracket using the screws provided. (Fig. 13)
- Switch ON mains power supply to the fan. Test the fan operations or enjoy using the fan following instructions under the "USING YOUR CEILING FAN" section of this instruction manual.

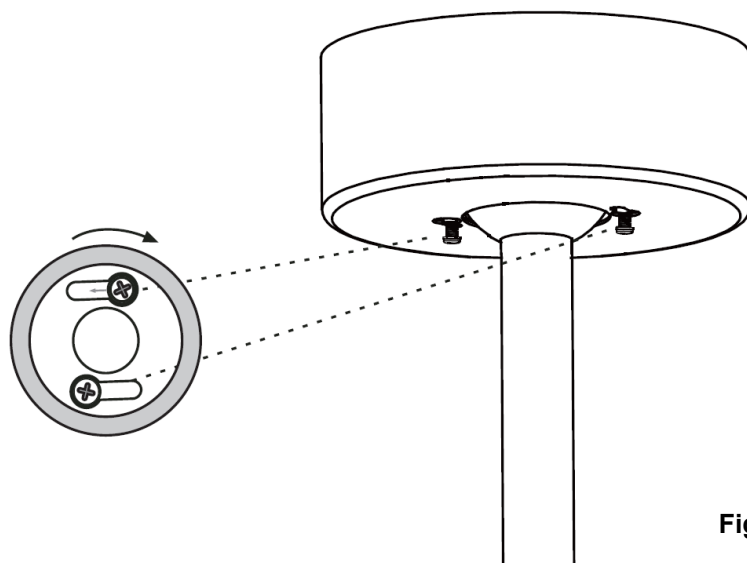

Fig. 12



# Cardinal Fan Installation Instructions

## USING YOUR CEILING FAN

Turn on the power and check the operation of the fan.

### LIGHT CONTROL

- Toggle Switch – On/off

The LED globe has a 3-step dimmable function which is controlled by an ON/OFF switch. Toggle the switch ON/OFF to the luminaire 4 times within 5 seconds, the globe will light up in the following order:

100% brightness → 50% brightness → 15% brightness → 100% brightness.

To switch back to 100% brightness at any stage, turn OFF the luminaire, and then wait after 5 seconds turn ON the luminaire, it will reset to 100% brightness.

### REVERSING SWITCH

Your ceiling fan can operate in either summer or winter mode. (Fig 13)

**SUMMER Mode:** The reverse switch shall be in the **SUMMER** position to make the fan rotate in an anticlockwise direction. The airflow will be directed downwards, for cooling in summer.

**WINTER Mode:** The reverse switch shall be in the **WINTER** position to make the fan rotate in a clockwise direction. The airflow will be directed upwards assisting in the circulation of warm air, for energy conservation in winter.

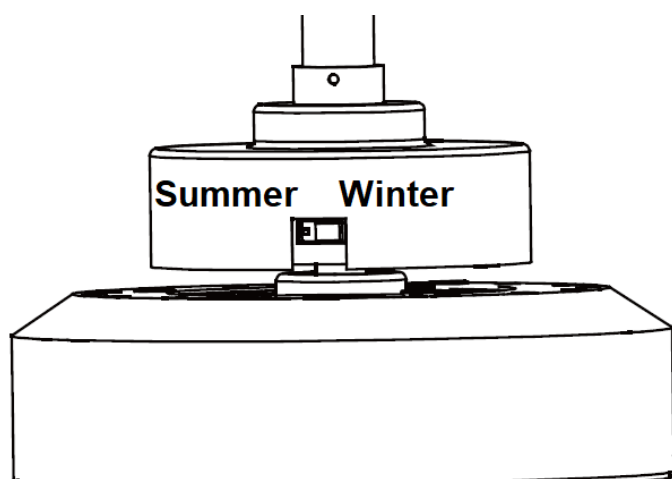
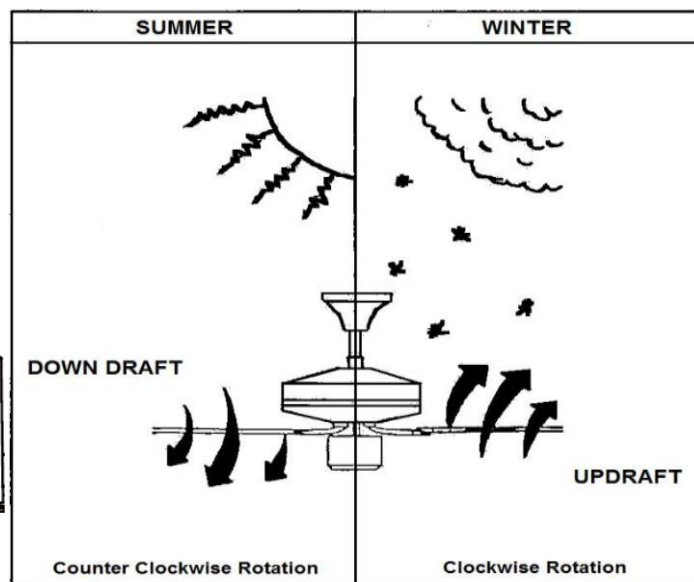

Fig. 13



## AFTER INSTALLATION

### WOBBLE:

NOTE: Ceiling fans tend to move during operation due to the fact that they are mounted on a rubber grommet. If the fan was mounted rigidly to the ceiling it would cause excessive vibration. Movement of a few centimetres is quite acceptable and DOES NOT suggest any problem.

# Cardinal Fan Installation Instructions

**TO REDUCE THE FAN WOBBLE:** Please check that all screws which fix the mounting bracket and down rod are secure.

**BALANCING KIT:** A balancing kit is provided to balance the ceiling fan on initial installation. Please refer to the instruction on how to use the balancing kit. The balancing kit can be used to assist re-balancing should the ceiling fan become un-balanced again. Store your balancing kit away after installation for future use if required.

## **NOISE:**

When it is quiet (especially at night) you may hear occasional small noises. Slight power fluctuations and frequency signals superimposed in the electricity for off-peak hot water control, may cause a change in fan motor noise. This is normal. Please allow a 24-hour “breaking-in” period, most noises associated with a new fan disappear during this time. Please note that this is not a product fault and as such is not covered under warranty – All electric motors are audible to some extent.

## **CARE AND CLEANING:**

**NOTE:** Always turn OFF the power at the mains switch before performing any maintenance or attempting to clean your fan.

- Every 6 months periodic cleaning of your ceiling fan is the only maintenance required. Use a soft brush or lint free cloth to avoid scratching the paint finish. Please turn off electricity power when you do so.
- Do not soak or immerse your ceiling fan in the water or other liquids. It could damage the motor or the blades and create the possibility of an electrical shock.
- Ensure that the fan does not come in contact with any organic solvents or cleaners.
- To clean the fan blade, wipe with only a damp clean cloth with NO organic solvents or cleaners.
- The motor has a permanently lubricated ball bearing so there is no need to oil.

## TECHNICAL INFORMATION

Fan Models	2526	2529
Finish	Matt black and Paulownia	Matt white and White wash
Rated Voltage	220-240V~ 50Hz	
Rated Wattage (Motor)	80W AC	
Rated wattage (Lamp)	GX53,12W, 3 step-dim (Not included)	
Weight	6.7kg	
Overall size	L:1410mm x H:335mm	
Canopy Dimensions	H:50mm Dia:130mm	
Battery for remote	2 x 1.5VAAA (Not included)	

# ZEBBIES CEILING FAN WARRANTY DETAIL

Every Zebbies ceiling fan is thoroughly inspected and tested before being released for sale. In addition to any warranty rights or conditions under statutory regulations, Zebbies warrants all of its ceiling fans against defective workmanship and faulty materials for twenty four (24) months from the date of purchase. Zebbies undertakes, at its option, to repair or replace, free of charge, each product or part thereof on condition that;

1. The fan or relevant part has not been subjected to misuse, neglect, or been involved in an accident.
2. The repairs are not required as a result of normal wear and tear.
3. The product was installed by a licensed electrical contractor.
4. A copy of the original receipt of purchase is presented.
5. 2 year warranty applies when used in domestic applications only.
6. This warranty does not cover stains, scratch and scuff marks, or dents if the product is purchased through a factory outlet or to refurbished items.

Our goods come with guarantees that cannot be excluded under the South Africa Consumer Law. You are entitled to a replacement or refund for a major failure and compensation for any other reasonably foreseeable loss or damage. You are also entitled to have the goods repaired or replaced if the goods fail to be of acceptable quality and the failure does not amount to a major failure.

**Zebbies cannot be held responsible for any repair other than those carried out by it or one of its Authorised Service Agents. Please keep this warranty information in a safe place. This information must be produced in the event of service being required.**

## CEILING FAN WARRANTY INFORMATION

Complete and retain this form for your personal records and warranty purposes.

NAME.....

ADDRESS.....

.....POSTCODE.....

MODEL NUMBER.....

(PO# + DATECODE Sticker here)

PO NUMBER or DATECODE .....

DATE OF PURCHASE.....

# Cardinal Fan Installation Instructions

---

INSTALLING LICENSED ELECTRICIAN.....  
.....

LICENCE No.....

ATTACH PROOF OF PURCHASE HERE

THIS COMPLETED DETAIL PAGE SHOULD BE PRODUCED AND SENT TO THE  
WHOLESALE OR THEIR AUTHORISED AGENTS BEFORE OBTAINING  
WARRANTY SERVICE